

CONTENTS

12 - 43	TURBINES A tradition of innovation and excellence	1
44 - 63	CONTRA-ANGLES AND HANDPIECES Unfailing precision	2
64 - 85	MICROMOTORS Ahead of the field	3
86 - 101	ELECTRONIC CONTROLS The very best motors demand the most high-performance controls	4
102 - 119	IMPLANTOLOGY To meet the most exacting requirements	5
120 - 135	COUPLINGS AND HOSES Change instruments with the greatest of ease	6
136 - 143	MAINTENANCE PRODUCTS Simplified maintenance	7
144 - 153	ACCESSORIES AND CONTROL INSTRUMENTS	8
154 - 163	CONDITIONS General terms and conditions of sale and warranty Tool standards References and pages	9

HE GAVE ME BACK MY SMILE

I closed my eyes, breathed in the fresh air. With the deepest sense of well-being and confidence that only the happiest moments bring.

I thought about my day again and surprised myself by smiling, for no particular reason, at the slightest thing.

I've every reason to smile.





MY PATIENTS AND I EXPECT THE SAME THING: THE VERY BEST

It's true, I'm demanding. Perfection motivates me, while beauty inspires and revitalizes me. I love elegance and simplicity, often synonymous with life's unforgettable experiences. In both my personal and professional life, I always strive to do better, to create more beauty, to give sense to the simplest things. Every day, my instruments help me to achieve this.



TECHNOLOGIES AND INSPIRATION

A world leader at your service for over 50 years

Producing the best instruments to simplify the work of practitioners and constantly improve patient comfort. This has been Bien-Air's mission since its creation in 1959.

Ergonomics, precision and reliability are at the core of the development of every new product. Paying careful attention to professionals every day, Bien-Air has made numerous innovations, always setting the bar higher. A true culture of excellence sitting perfectly with the tradition of Swiss Made products from the renowned Watch Valley.

Our promise for the future is to continue to innovate, to offer you the most advanced and most reliable instruments. Facilitating your work, day in, day out. For the comfort of your patients.





WELCOME TO A WORLD OF EXCELLENCE



LED QUALITY

Unrivalled light. Bien-Air is setting new standards. For its LED light solution, Bien-Air has gone to great lengths to combine the best components available with application techniques to guarantee unique levels of performance and reliability. Bien-Air LED lighting offers unmatched working comfort. Intensity can be adjusted from 0 to 38,000 lux. It significantly improves visibility of the working area and diffuses a perfectly white and natural light.

For sterilizable instruments, the perfect encapsulation of the LED in sealed optical glass guarantees its resistance to hundreds of autoclave cycles. The absence of infra-red emission prevents the instrument or motor from overheating.



BLACKLINE

Light, slim and ultra-resistant: Blackline handles made from vacuum-molded carbon fiber have set a new technological standard. The carbon fiber is 3 times lighter than titanium (1.8 g/cm^3) and will withstand 10,000 sterilization cycles leaving no signs of deterioration. Free from porosity, BLACKLINE handles guarantee perfect hygiene and grip and great dynamic stability, even with repeated sterilization. As well as offering you unrivalled comfort, BLACKLINE instruments will retain their pristine appearance over a very long period.



CERAMIC REVOLUTION

Longer service life, greater precision. Less noise, less vibrations. Superior-quality Bien-Air ball bearings, made from silicon nitride (ceramic), are in a class of their own thanks to their significantly reduced wear compared with traditional bearings. Furthermore, they are able to withstand high temperatures, are resistant to corrosion and offer electrostatic insulation, while remaining the lighter option. CERAMIC REVOLUTION. For extreme performance.



ACCU-CHUCK

The precision of the practitioner's movements must be relayed to the patient with no interference of any kind. This is why it is so important that your instrument is as precise as possible. The locking and drive technologies in Bien-Air's rotary instruments are the most precise on the market. And this is not by pure chance. The unique procedures illustrate the Swiss quality which has earned Bien-Air its credentials and reputation: parts machined to the exact micron, rectified and honed, for enhanced reliability and reduced noise levels. This gives the instruments perfect equilibrium, free from any imbalance or vibration. Their unique precision and reliability will make them indispensable. And an additional advantage - your burs will last longer.





SMART LOGIC

With the benefit of Bien-Air's SMART LOGIC technology, enjoy the most precise control ever obtained with a micromotor. Cutting-edge electronics control the micromotor's torque and rotation speed to perfection, even at very low speed. An additional guarantee of reliability, the SMART technology controls the micromotor's rotation despite the absence of any sensors. SMART LOGIC. The best of Swiss engineering.



DUALOOK LIGHTING

DUALOOK is exclusive to Bien-Air. In addition to being rugged under all conditions, the two glass fiber rods provide an enveloping, non-dazzling light. Its two offset sources allow you to see depth clearly and accurately. Areas in shadow are virtually eliminated from the working area, including in front of the bur. What if your car only had one headlight? DUALOOK: the best lighting on the market.



ACCU-SPRAY

Research conducted by Bien-Air engineers has clearly demonstrated the superior cooling power of six separate air and water nozzles. With the ACCU-SPRAY system, the air disperses the water to a highly precise point before contact with the bur. The ultra-precise nebulization this provides cools the bur and the dental material as efficiently as possible. It also guarantees perfect visibility of the working area. The separate water and air ducts also prevent blockages.



**COOL TOUCH
ANTI-HEATING PUSH-BUTTON**

Bien-Air is the only manufacturer in the world to offer a push-button bur change mechanism with an anti-heating safety system. This reduces the risk of burning your patients with the head of your instrument. A tungsten carbide ball is placed between the push-button and the top of the housing of the tool's bur locking mechanism. It absorbs heat in the event of contact when rotating. COOL TOUCH. An exclusive invention for your comfort and your patients' safety.



A TRADITION OF INNOVATION AND EXCELLENCE

The most advanced technology, the most refined ergonomics: Bien-Air turbines have always been characterized by this perfect balance. The new line of Blackline turbines in carbon fiber and with LED light provide the most perfect example of this. In creating the Blackline range, Bien-Air is perpetuating a tradition of innovation and high technology. Indeed, our company invented the first reliable turbine in history way back in 1959. A succession of revolutionary innovations followed: the first push-button bur change mechanism, air bearing technology, the first quick-connect coupling connection, and many others are amongst our extensive list of achievements. These innovations have always contributed to making our turbines unique. Bien-Air turbines are on the cutting edge.

TURBINES



BORA TURBINES



Imagine a high-performance instrument so incredibly light and fine, yet sleek and strong. Inspired by the latest technological advances in the most demanding fields such as aeronautics, sailing and competitive sports, the Blackline Bora incorporates a carbon fiber handle.

Incredibly powerful, robust and reliable, Bora turbines boast the very best of Bien-Air technology. They guarantee impeccable hygiene thanks to the Sealed Head air non-return valve and perfect nebulization with the three separate Accu-Spray air/water sprays. Finally, they have the Cool Touch push-button bur locking mechanism which reduces heating. An additional comfort your patients are sure to appreciate.

Bora turbines are available in Blackline or in the classic version, available with DualLook LED light or without light.



BLACKLINE

Light, slim and ultra-resistant: BLACKLINE handles made from vacuum-molded carbon fiber have set a new technological standard.



LED QUALITY

Bien-Air is setting new standards in the field of LED lighting. Adjustable intensity from 0 to 38 000 lux, perfectly white and natural light, service life up to 10 times longer than that of a traditional bulb, no heating, exceptional resistance to sterilization.



DUALOOK

In addition to being rugged under all conditions, the two glass fiber rods give an enveloping, non-dazzling light, clearly showing depth. DUALOOK: the best lighting on the market.



ACCU-SPRAY

Cooling with six separate air and water nozzles. The ultra-precise nebulization this provides cools the bur and the dental material as efficiently as possible.



CERAMIC REVOLUTION

Longer service life, greater precision. Less noise, less vibrations. Superior quality Bien-Air ceramic ball bearings. For extreme performance.



ACCU-CHUCK

The most precise bur locking and rotation drive technology in the world. Discover instruments with perfect equilibrium, free from any imbalance or vibration. The best of Swiss technology.



COOL TOUCH

Push-button with an anti-heating safety system. This reduces the risk of burning your patients with the head of your instrument. For your comfort and your patients' safety.



SEALED HEAD

In combination with the anti-return valve, a Teflon® lip prevents any residues or contaminants entering the instrument. Enhanced hygiene and reliability.



SOFT PUSH

Bien-Air's unique push-button insert locking mechanism. Light pressure is all that is needed. Bur changing is quick and comfortable. This mechanism guarantees firm yet precise locking.

BORA TURBINES WITH LIGHT



Bora L Blackline

320,000 rpm, 2.7 bars, 3 sprays, push-button bur locking, water anti-retraction valve, fast, rotating connection for Unifix quick-connect coupling

Ref. 1600637-001



Bora L Blackline + 4-way Unifix set

320,000 rpm, 2.7 bars, 3 sprays, push-button bur locking, water anti-retraction valve, fast, rotating connection with 4-way electric powered Unifix coupling fitted with a non-return valve on the air exhaust

Ref. 1700303-001



Bora L

320,000 rpm, 2.7 bars, 3 sprays, push-button bur locking, water anti-retraction valve, fast, rotating connection for Unifix quick-connect coupling

Ref. 1600638-001



Bora L + 4-way Unifix set

320,000 rpm, 2.7 bars, 3 sprays, push-button bur locking, water anti-retraction valve, fast, rotating connection with 4-way electric powered Unifix coupling fitted with a non-return valve on the air exhaust

Ref. 1700305-001



Non-sterilizable couplings.

BORA TURBINES WITH LIGHT



Bora L

320,000 rpm, 2.7 bars, 3 sprays, push-button bur locking, water anti-retraction valve, fast, rotating connection for Unifix quick-connect coupling

Ref. 1600382-001



Bora L + 4-way Unifix set

320,000 rpm, 2.7 bars, 3 sprays, push-button bur locking, water anti-retraction valve, fast, rotating connection with 4-way electric powered Unifix coupling fitted with a non-return valve on the air exhaust

Ref. 1700189-001



Bora LK

320,000 rpm, 3 bars, 3 sprays, push-button bur locking, fast, rotating connection for MULTiflex® Kavo® coupling. Coupling not supplied.

Ref. 1600155-001



Non-sterilizable couplings.

BORA TURBINES WITHOUT LIGHT



Bora

320,000 rpm, 2.7 bars, 3 sprays, push-button bur locking, water anti-retraction valve, fast, rotating connection for Unifix quick-connect coupling

Ref. 1600381-001



Bora L + 3-way Unifix set

320,000 rpm, 2.7 bars, 3 sprays, push-button bur locking, water anti-retraction valve, fast, rotating connection, with 3-way Unifix coupling

Ref. 1700187-001



Bora + 4-way Unifix set

320,000 rpm, 2.7 bars, 3 sprays, push-button bur locking, water anti-retraction valve, fast, rotating connection, with 4-way Unifix coupling

Ref. 1700188-001



PRESTIGE TURBINES

The perfect complement to a Bora turbine. The smaller head size of the Prestige turbines make them ideal for delicate work. They are particularly noteworthy for their lightness and ease of handling. Prestige and Bora make perfect partners for a wide range of restoration work.

Prestige turbines are quieter than ever. They guarantee perfect nebulization due to the three separate Accu-Spray air/water sprays. Finally, they have a Cool Touch push-button system which reduces heating. An additional comfort your patients are sure to appreciate.

Prestige turbines are available in Blackline or in the classic version, available with DuaLook LED light or without light.



BLACKLINE

Light, slim and ultra-resistant: BLACKLINE handles made from vacuum-molded carbon fiber have set a new technological standard.



LED QUALITY

Bien-Air is setting new standards in the field of LED lighting. Adjustable intensity from 0 to 38 000 lux, perfectly white and natural light, service life up to 10 times longer than that of a traditional bulb, no heating, exceptional resistance to sterilization.



DUALOOK

In addition to being rugged under all conditions, the two glass fiber rods give an enveloping, non-dazzling light, clearly showing depth. DUALOOK: the best lighting on the market.



ACCU-SPRAY

Cooling with six separate air and water nozzles. The ultra-precise nebulization this provides cools the bur and the dental material as efficiently as possible.



CERAMIC REVOLUTION

Longer service life, greater precision. Less noise, less vibrations. Superior quality Bien-Air ceramic ball bearings. For extreme performance.



ACCU-CHUCK

The most precise bur locking and rotation drive technology in the world. Discover instruments with perfect equilibrium, free from any imbalance or vibration. The best of Swiss technology.



COOL TOUCH

Push-button with an anti-heating safety system. This reduces the risk of burning your patients with the head of your instrument. For your comfort and your patients' safety.



SOFT PUSH

Bien-Air's unique push-button insert locking mechanism. Light pressure is all that is needed. Bur changing is quick and comfortable. This mechanism guarantees firm yet precise locking.

PRESTIGE TURBINES WITH LIGHT



Prestige L Blackline

315,000 rpm, 3.2 bars, 3 sprays, push-button bur locking, water anti-retraction valve, fast, rotating connection for Unifix quick-connect coupling

Ref. 1600640-001



Prestige L Blackline + 4-way Unifix set

315,000 rpm, 3.2 bars, 3 sprays, push-button bur locking, water anti-retraction valve, fast, rotating connection with 4-way electric powered Unifix coupling fitted with a non-return valve on the air exhaust

Ref. 1700304-001



Prestige L

315,000 rpm, 3.2 bars, 3 sprays, push-button bur locking, water anti-retraction valve, fast, rotating connection for Unifix quick-connect coupling

Ref. 1600641-001



Prestige L + 4-way Unifix set

315,000 rpm, 3.2 bars, 3 sprays, push-button bur locking, water anti-retraction valve, fast, rotating connection with 4-way electric powered Unifix coupling fitted with a non-return valve on the air exhaust

Ref. 1700306-001



Non-sterilizable couplings.



PRESTIGE TURBINES WITH LIGHT



Prestige L

335,000 rpm, 3.2 bars, 3 sprays, push-button bur locking, water anti-retraction valve, fast, rotating connection for Unifix quick-connect coupling

Ref. 1600380-001



Prestige L + 4-way Unifix set

335,000 rpm, 3.2 bars, 3 sprays, push-button bur locking, water anti-retraction valve, fast, rotating connection with 4-way electric powered Unifix coupling fitted with a non-return valve on the air exhaust

Ref. 1700184-001



PRESTIGE TURBINES WITHOUT LIGHT



Prestige

315,000 rpm, 3.2 bars, 3 sprays, push-button bur locking, water anti-retraction valve, fast, rotating connection for Unifix quick-connect coupling

Ref. 1600379-001



Prestige L + 3-way Unifix set

315,000 rpm, 3.2 bars, 3 sprays, push-button bur locking, water anti-retraction valve, fast, rotating connection, 3-way Unifix coupling

Ref. 1700185-001



Prestige + 4-way Unifix set

315,000 rpm, 3.2 bars, 3 sprays, push-button bur locking, water anti-retraction valve, fast, rotating connection, with 4-way Unifix coupling

Ref. 1700186-001



GYRO TURBINES



Gyro turbines have a long service life. A very long service life. Their secret lies in their world-exclusive air bearings. These significantly reduce contact between moving parts thus guaranteeing minimal wear. This makes them almost maintenance-free. A particular feature of Gyro turbines is their ultra-high rotation speed. This is the ideal turbine for work requiring control and dexterity.



DUALOOK

In addition to being rugged under all conditions, the two glass fiber rods give an enveloping, non-dazzling light, clearly showing depth. DUALOOK: the best lighting on the market.



ACCU-SPRAY

Cooling with six separate air and water nozzles. The ultra-precise nebulization this provides cools the bur and the dental material as efficiently as possible.



ACCU-CHUCK

The most precise bur locking and rotation drive technology in the world. Discover instruments with perfect equilibrium, free from any imbalance or vibration. The best of Swiss technology.



FREE MOVE

Freedom of movement for optimum working comfort. Thanks to its flexible and light rotating quick-connect coupling, the Bien-Air motor/turbine/hose combination will prove a pleasant work companion day in, day out.



SWISS MADE

Only the most sophisticated techniques and the best materials make it possible to manufacture the best products. Bien-Air products are designed and manufactured in the heart of Watch Valley in Switzerland. After manufacture, Bien-Air products undergo individual testing.

GYRO TURBINES WITH LIGHT SCREW CHUCK



Gyro L

Turbine with air bearings, 470,000 rpm, 3.7 bars, 3 sprays, screw chuck, water anti-retraction valve, fast, rotating connection for Unifix quick-connect coupling

Ref. 1600378-001



Gyro L + 4-way Unifix set

Turbine with air bearings, 470,000 rpm, 3.7 bars, 3 sprays, screw chuck, water anti-retraction valve, fast, rotating connection, with 4-way electric powered Unifix coupling fitted with an air non-return valve

Ref. 1700190-001



**GYRO TURBINES WITHOUT LIGHT
SCREW CHUCK**



Gyro

Turbine with air bearings, 470,000 rpm, 3.7 bars, 3 sprays, screw chuck, water anti-retraction valve, fast, rotating connection for Unifix quick-connect coupling

Ref. 1600377-001



Gyro + 3-way Unifix set

Turbine with air bearings, 470,000 rpm, 3.7 bars, 3 sprays, screw chuck, water anti-retraction valve, fast, rotating connection for Unifix 3-way quick-connect coupling

Ref. 1700193-001



Gyro + 4-way Unifix set

Turbine with air bearings, 470,000 rpm, 3.7 bars, 3 sprays, screw chuck, water anti-retraction valve, fast, rotating connection for 4-way Unifix quick-connect coupling

Ref. 1700194-001



**GYRO TURBINES WITHOUT LIGHT
FRICTION GRIP (FG)**



Gyro FG

Turbine with air bearings, 470,000 rpm, 3.7 bars, 3 sprays, friction grip (FG), water anti-retraction valve, fast, rotating connection for Unifix quick-connect coupling

Ref. 1600376-001



Gyro FG + 3-way Unifix set

Turbine with air bearings, 470,000 rpm, 3.7 bars, 3 sprays, friction grip (FG), water anti-retraction valve, fast, rotating connection, with 3-way Unifix coupling

Ref. 1700191-001



Gyro FG + 4-way Unifix set

Turbine with air-bearings, 470,000 rpm, 3.7 bars, 3 sprays, friction grip (FG), water anti-retraction valve, fast, rotating connection for 4-way Unifix coupling

Ref. 1700192-001



BORALINA, PRESTILINA AND GYROLINA TURBINES

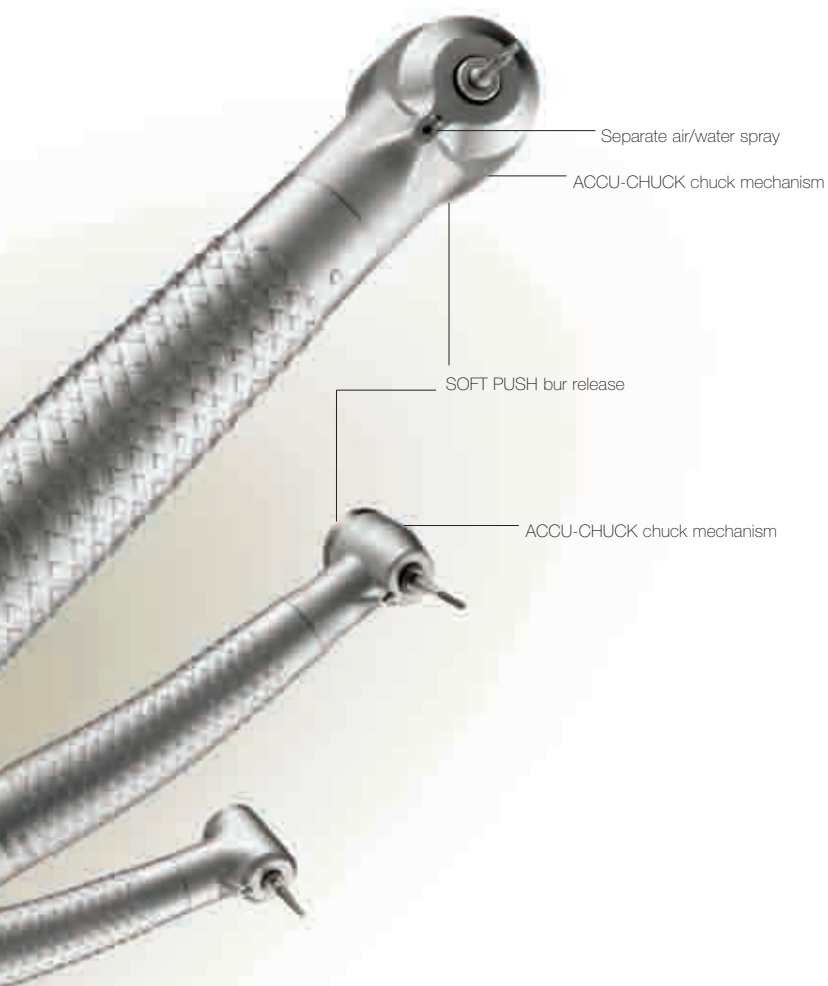

Economical turbines offering unrivalled value for your money. Although they offer the same features of power and delicacy as their big cousins, they boast a simplified design with 1 separate air/water spray and without a light. They connect to a Bien-Air Unifix quick-connect coupling.



ACCU-CHUCK

The most precise bur locking and rotation drive technology in the world. Discover instruments with perfect equilibrium, free from any imbalance or vibration. The best of Swiss technology.



SOFT PUSH

Bien-Air's unique push-button insert locking mechanism. Light pressure is all that is needed. Bur changing is quick and comfortable. This mechanism guarantees firm yet precise locking.



FREE MOVE

Freedom of movement for optimum working comfort. Thanks to its flexible and light rotating quick-connect coupling, the Bien-Air motor/turbine/hose combination will prove a pleasant work companion day in, day out.



SWISS MADE

Only the most sophisticated techniques and the best materials make it possible to manufacture the best products. Bien-Air products are designed and manufactured in the heart of Watch Valley in Switzerland. After manufacture, Bien-Air products undergo individual testing.

BORALINA TURBINES WITHOUT LIGHT

Quality and long service life at a competitive price. Boralina is a simplified version of the Bora turbine, without a light and with one spray. Designed along the same lines as its big cousin, it is remarkably powerful and rugged. Instrument changing could not be simpler, thanks to the Unifix quick-connect coupling.



Boralina

310,000 rpm, 2.7 bars, 1 spray,
push-button bur locking, fast, rotating connection
for Unifix coupling

Ref. 1600373-001



Boralina + 3-way Unifix set

310,000 rpm, 2.7 bars, 1 spray,
push-button bur locking, fast, rotating connection
with 3-way Unifix coupling

Ref. 1700200-001



Boralina + 4-way Unifix set

310,000 rpm, 2.7 bars, 1 spray,
push-button bur locking, fast, rotating connection
with 4-way Unifix coupling

Ref. 1700201-001



PRESTILINA TURBINES WITHOUT LIGHT

Quality and long service life at a competitive price. Prestilina is a simplified version of the Prestige turbine, without a light and with one spray. Designed along the same lines as its big cousin, it is remarkably accurate and easy to handle. Instrument changing could not be simpler, thanks to the Unifix quick-connect coupling.



Prestilina

410,000 rpm, 2.5 bars, 1 spray,
push-button bur locking, fast, rotating connection
for Unifix coupling

Ref. 1600372-001



Prestilina + 3-way Unifix set

410,000 rpm, 2.5 bars, 1 spray,
push-button bur locking, fast, rotating connection
with 3-way Unifix coupling

Ref. 1700198-001



Prestilina + 4-way Unifix set

410,000 rpm, 2.5 bars, 1 spray,
push-button bur locking, fast, rotating connection
with 4-way Unifix coupling

Ref. 1700199-001



Non-sterilizable couplings.

GYROLINA TURBINES WITHOUT LIGHT

Quality and long service life at a competitive price. Gyrolina is inspired by the Gyro turbine. Of simpler design, it has one spray and no light. It nevertheless offers the same advantages: minimal parts wear and maintenance. Instrument changing could not be simpler, thanks to the Unifix quick-connect coupling.



Gyrolina

Turbine with air bearings, 440,000 rpm, 3.7 bars, 1 spray, friction grip (FG), fast, rotating connection for Unifix coupling

Ref. 1600371-001



Gyrolina + 3-way Unifix set

Turbine with air bearings, 440,000 rpm, 3.7 bars, 1 spray, friction grip (FG), fast, rotating connection, with 3-way Unifix coupling

Ref. 1700202-001



Gyrolina + 4-way Unifix set

Turbine with air bearings, 440,000 rpm, 3.7 bars, 1 spray, friction grip (FG), fast, rotating connection, with 4-way Unifix coupling

Ref. 1700203-001



Non-sterilizable couplings.



EOLIA B TURBINE

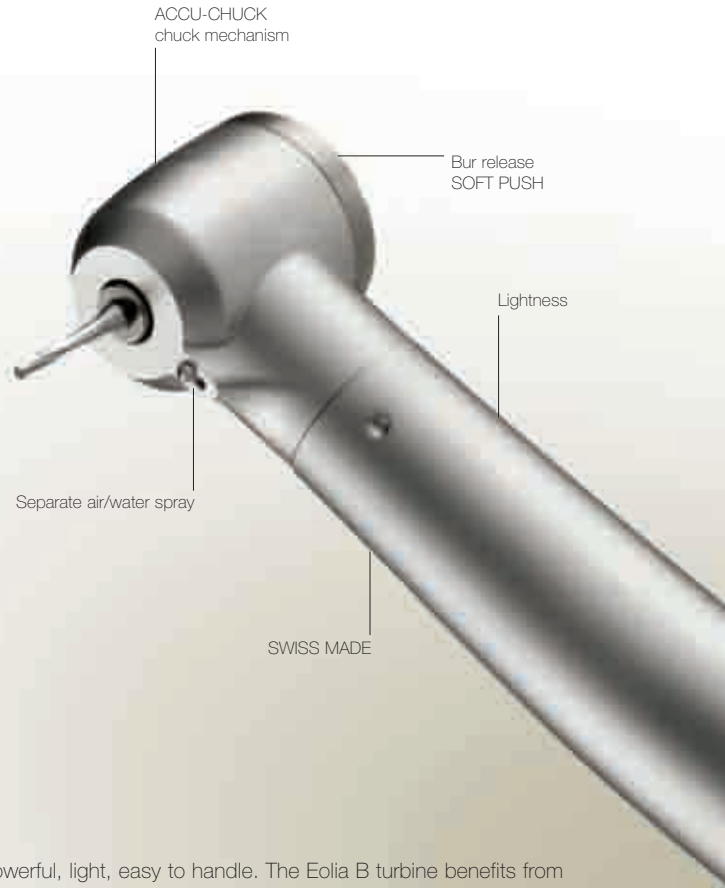

Powerful, light, easy to handle. The Eolia B turbine benefits from Bien-Air's vast experience in turbine design. Eolia B offers the quality of a Swiss Made instrument at a highly competitive price. It boasts comfortable push-button bur locking and water non-return valve for impeccable hygiene. Instrument changing could not be simpler thanks to its new metal bayonet coupling.



ACCU-CHUCK

The most precise bur locking and rotation drive technology in the world. Discover instruments with perfect equilibrium, free from any imbalance or vibration. The best of Swiss technology.



SOFT PUSH

Bien-Air's unique push-button insert locking mechanism. Light pressure is all that is needed. Bur changing is quick and comfortable. This mechanism guarantees firm yet precise locking.



SWISS MADE

Only the most sophisticated techniques and the best materials make it possible to manufacture the best products. Bien-Air products are designed and manufactured in the heart of Watch Valley in Switzerland. After manufacture, Bien-Air products undergo individual testing.

EOLIA B TURBINES WITHOUT LIGHT



Eolia B

315,000 rpm, 2.5 bars, 1 spray,
push-button bur locking, for 2-3 or 4-way
quick-connect bayonet coupling

Ref. 1600465-001



Eolia B + 2-3 way coupling set

315,000 rpm, 2.5 bars, 1 spray,
push-button bur locking, with 2-3 way
quick-connect bayonet coupling

Ref. 1700225-001



Eolia B + 4-way coupling set

315,000 rpm, 2.5 bars, 1 spray,
push-button bur locking, water anti-retraction valve,
with 4-way quick-connect bayonet coupling

Ref. 1700226-001



Non-sterilizable couplings.



BLACK PEARL ECO TURBINES

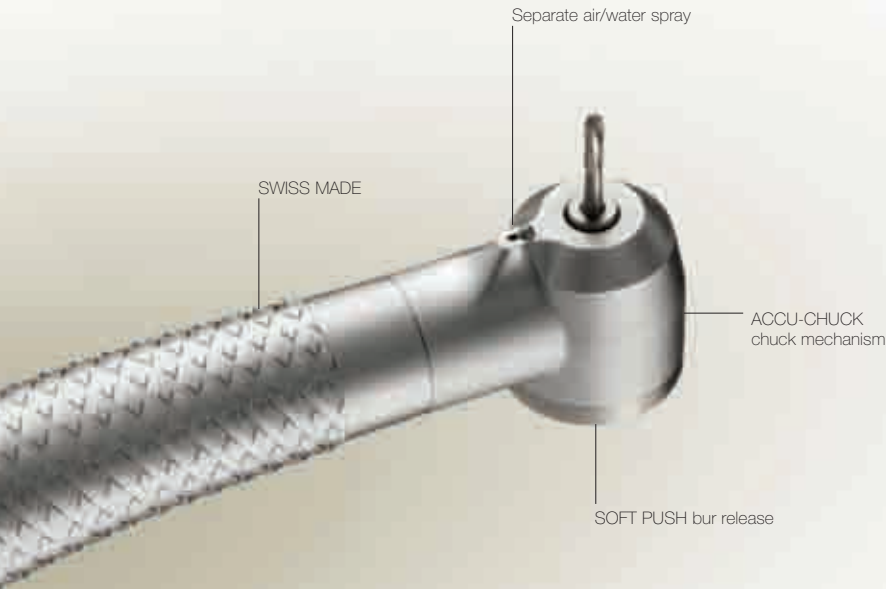

Its competitive price sets the Black Pearl Eco apart. It has one separate air/water spray and connects directly to a 3 or 4-way hose. Its moderately sized head makes this the versatile turbine par excellence. A classic instrument.



ACCU-CHUCK

The most precise bur locking and rotation drive technology in the world. Discover instruments with perfect equilibrium, free from any imbalance or vibration. The best of Swiss technology.



SOFT PUSH

Bien-Air's unique push-button insert locking mechanism. Light pressure is all that is needed. Bur changing is quick and comfortable. This mechanism guarantees firm yet precise locking.



SWISS MADE

Only the most sophisticated techniques and the best materials make it possible to manufacture the best products. Bien-Air products are designed and manufactured in the heart of Watch Valley in Switzerland. After manufacture, Bien-Air products undergo individual testing.



BLACK PEARL ECO TURBINES WITHOUT LIGHT, DIRECT CONNECTION

Black Pearl ECO 2-3 way

310,000 rpm, 2.5 bars, 1 spray, push-button bur locking, 2-3 way direct connections
Ref. 1600039-001



Black Pearl ECO 4-way

310,000 rpm, 2.5 bars, 1 spray, push-button bur locking, 4-way direct connection
Ref. 1600040-001



UNFAILING PRECISION

Even the best dentist is nothing without a good instrument. Bien-Air contra-angles and handpieces offer you the best of Swiss micro-technology. Designed and manufactured in the heart of Watch Valley, each instrument is a masterpiece of metal-working, where skills combine to create a rugged, ultra-precise and quiet device.

From endodontics and surgery to implantology and restoration, Bien-Air has the instrument you need.

Depending on their transmission ratios, they operate at between 10 and 200,000 rpm. Cutting-edge technological solutions developed by Bien-Air engineers optimize their performance even further, while at the same time constantly improving control, comfort and service life. Bien-Air contra-angles and handpieces will meet your every need, and more...

CONTRA-ANGLES AND HANDPIECES



CONTRA-ANGLES



Bien-Air contra-angles: marvels of precision, offering reliability and quiet operation. The culmination of a long tradition of excellence, Bien-Air contra-angles boast a Soft Push push-button for easy bur release, DuaLook dual glass rod lighting and three Accu-Spray separate air/water sprays guaranteeing perfect nebulization. Their ideal ergonomic characteristics ensure an excellent grip while guaranteeing perfect handling. The latest developments in Bien-Air contra-angles incorporate a new shaft and gear system mounted on pre-stressed ball bearings. This offers vibration-free transmission and reduces energy loss. These new Bien-Air shaft and gear systems simultaneously provide outstanding smoothness and improved sensitivity. For your comfort and that of your patient.



DUALOOK

In addition to being rugged under all conditions, the two glass fiber rods give an enveloping, non-dazzling light, clearly showing depth. DUALOOK: the best lighting on the market.



ACCU-SPRAY

Cooling with six separate air and water nozzles. The ultra-precise nebulization this provides cools the bur and the dental material as efficiently as possible.



ACCU-CHUCK

The most precise bur locking and rotation drive technology in the world. Discover instruments with perfect equilibrium, free from any imbalance or vibration. The best of Swiss technology.



COOL TOUCH

Push-button with an anti-heating safety system. This reduces the risk of burning your patients with the head of your instrument. For your comfort and your patients' safety.



SOFT PUSH

Bien-Air's unique push-button insert locking mechanism. Light pressure is all that is needed. Bur changing is quick and comfortable. This mechanism guarantees firm yet precise locking.



IDEAL GEOMETRY

Improved accessibility to areas at the rear of the mouth. Bien-Air contra-angles are designed to offer you improved handling, visibility and accessibility to the working area.



SWISS MADE

Only the most sophisticated techniques and the best materials make it possible to manufacture the best products. Bien-Air products are designed and manufactured in the heart of Watch Valley in Switzerland. After manufacture, Bien-Air products undergo individual testing.

CONTRA-ANGLES CA 1:5



CA 1:5 L

Speed increasing factor of 5, light via optical glass rod, push-button bur locking with anti-heating system, bur shank Ø 1.6 mm, anti-retraction valve

Ref. 1600386-001



CA 1:5

Speed increasing factor of 5, without light, push-button bur locking with anti-heating system, bur shank Ø 1.6 mm, anti-retraction valve

Ref. 1600325-001



CONTRA-ANGLES CA 1:1



CA 1:1 L

Direct ratio, light via optical glass rod, push-button bur locking, bur shank Ø 2.35 mm, anti-retraction valve

Ref. 1600384-001



CA 1:1

Direct ratio, without light, push-button bur locking, bur shank Ø 2.35 mm, anti-retraction valve

Ref. 1600424-001



CONTRA-ANGLES CA 10:1



CA 10:1 L

Speed reducing factor of 10, light via optical glass rod, push-button bur locking, bur shank Ø 2.35 mm

Ref. 1600385-001



CA 10:1

Speed reducing factor of 10, without light, push-button bur locking, bur shank Ø 2.35 mm

Ref. 1600425-001



1:1 INSTRUMENTS SETS WITH INTERNAL SPRAY



CA 1:1 L + PM 1:1 set

Comprising:

- 1 CA 1:1 L with light ref. 1600384-001
- 1 PM 1:1 without light ref. 1600383-001

Ref. 1700196-001



CA 1:1 + PM 1:1 set

Comprising:

- 1 CA 1:1 without light ref. 1600424-001
- 1 PM 1:1 without light ref. 1600383-001

Ref. 1700042-001



STRAIGHT HANDPIECES

The latest generation of handpieces are the result of our ongoing research and development work.

They are designed to withstand the stresses resulting from repeated lateral pressure, while maintaining exceptional precision.

You will also appreciate the absence of vibration, their quiet operation and their tried and tested bur locking system.

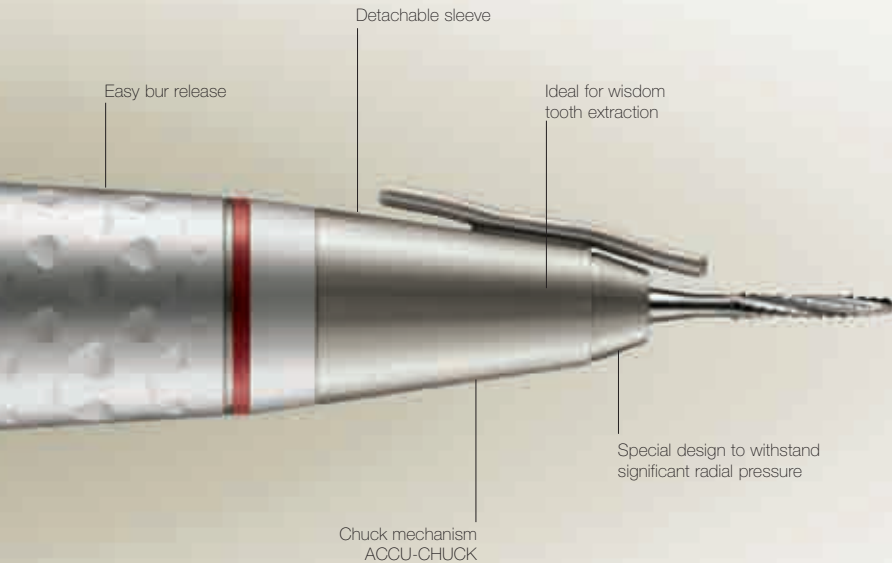

FREE MOVE

Freedom of movement for optimum working comfort. Thanks to its flexible and light rotating quick-connect coupling, the Bien-Air motor/turbine/hose combination will prove a pleasant work companion day in, day out.



SWISS MADE

Only the most sophisticated techniques and the best materials make it possible to manufacture the best products. Bien-Air products are designed and manufactured in the heart of Watch Valley in Switzerland. After manufacture, Bien-Air products undergo individual testing.

STRAIGHT HANDPIECES PM 1:1



PM 1:1

Without light, direct ratio,
with internal spray, locking ring,
bur shank Ø 2.35 mm

Ref. 1600383-001



PM 1:1 external irrigation

Without light, direct ratio, interchangeable sleeves
with or without irrigation tube,
locking ring, tool shank Ø 2.35 mm

Ref. 1600052-001



STRAIGHT HANDPIECE PM 1:2



PM 1:2 external irrigation

Without light, speed increasing factor of 2,
interchangeable sleeves with or without irrigation tube,
locking ring, bur shank Ø 2.35 mm

Ref. 1600436-001



IMPLANTOLOGY INSTRUMENTS

Thanks to the outstanding ergonomic design of the new Bien-Air 20:1 L implantology contra-angle handpiece, the word «comfort» takes on a whole new meaning.

This contra-angle handpiece has an irrigation system which is internal to the instrument – the world's first. So your grip is not impeded by the irrigation line. The jet of physiological liquid is projected onto the drill shaft itself, providing perfect cooling, particularly when using implant guides for insertions.

In addition, its shafts and gears are machined in stainless steel with high resistance to saline solutions.

The 20:1 L contra-angle handpiece is abound with superlatives: the smallest head, the lightest contra-angle on the market, exceptional DualLook lighting, Soft Push easy-release push-button...

The benchmark in implantology instruments.



DUALOOK

In addition to being rugged under all conditions, the two glass fiber rods give an enveloping, non-dazzling light, clearly showing depth. DUALOOK: the best lighting on the market.



ACCU-CHUCK

The most precise bur locking and rotation drive technology in the world. Discover instruments with perfect equilibrium, free from any imbalance or vibration. The best of Swiss technology.



SOFT PUSH

Bien-Air's unique push-button insert locking mechanism. Light pressure is all that is needed. Bur changing is quick and comfortable. This mechanism guarantees firm yet precise locking.



IDEAL GEOMETRY

Improved accessibility to areas at the rear of the mouth. Bien-Air contra-angles are designed to offer you improved handling, visibility and accessibility to the working area.



SWISS MADE

Only the most sophisticated techniques and the best materials make it possible to manufacture the best products. Bien-Air products are designed and manufactured in the heart of Watch Valley in Switzerland. After manufacture, Bien-Air products undergo individual testing.

IMPLANTOLOGY CONTRA-ANGLES
INTERNAL IRRIGATION



CA 20:1 L

Internal irrigation, light via optical glass rod,
speed reducing factor of 20, push-button bur locking,
bur shank \varnothing 2.35 mm

Ref. 1600598-001



CA 20:1

Internal irrigation, without light,
speed reducing factor of 20, push-button bur locking,
bur shank \varnothing 2.35 mm

Ref. 1600632-001



The 1:2 straight handpiece is the ideal instrument
for wisdom tooth extraction. It is characterized
by its cutting speed and ruggedness.



IMPLANTOLOGY CONTRA-ANGLES
REMOVABLE IRRIGATION TUBE



CA 1:1
Removable external irrigation, direct ratio,
without light, push-button bur locking, bur shank Ø 2.35 mm.
Irrigation set included ref. 1500431-010.
Ref. 1600200-001



CA 30:1
Removable external irrigation, speed reducing factor of 30,
without light, push-button bur locking, bur shank Ø 2.35 mm.
With Kirschner/Meyer removable irrigation system.
Irrigation set included ref. 1500467-010.
Ref. 1600284-001



IMPLANTOLOGY CONTRA-ANGLES
FIXED EXTERNAL IRRIGATION TUBE



CA 1122
Fixed external irrigation, direct ratio, without light,
push-button bur locking, bur shank Ø 2.35 mm.
Fixed side irrigation tube.
Ref. 1600603-001



CA 30121
Fixed external irrigation, speed reducing factor of 30,
without light, push-button bur locking, bur shank Ø 2.35 mm.
With Kirschner/Meyer removable irrigation system.
Irrigation set included ref. 1500028-001
Ref. 1600479-001



POWERCARE ULTRASONIC SCALER

Thanks to its high-precision piezo technology, the POWERCARE ultrasonic scaler distributed by Bien-Air emerges as the instrument of choice for the removal of deposits and supragingival and subgingival dental prophylaxis.

Powercare controls and automatically adjusts the power necessary for each operation. This guarantees you optimal efficiency during your work. For their part, your patients benefit from enhanced comfort.

With its lightweight and ergonomic handle, Powercare offers you visibility and excellent handling. It is supplied with a basic kit to which a wide range of high-performance inserts can be added.

Powercare. Take control.



High-performance inserts

Ergonomic design offering you visibility and excellent handling.

Lightweight

ULTRASONIC SCALER



Powercare Set

The POWERCARE set has been designed for integration into the dental unit.

Power variation can be controlled by a potentiometer (not supplied). The Powercare's case can be used as a holder during sterilization. A torque wrench is provided for secure locking. A wide range of high-performance inserts covering the main prophylactic applications is available.

Set contents:

1 Powercare ultrasonic scaler	ref. 1600674-001
1 scaler hose	ref. 1600675-001
1 torque wrench, sterilizable	ref. 1304239-001
1 electronic control	ref. 1304240-001
1 connector with wires, for potentiometer	ref. 1304417
1 box for scaler, sterilizable	ref. 1304241-001
1 support for inserts, sterilizable	ref. 1304242-001
2 S1 inserts	ref. 1304243-001
1 P1 insert	ref. 1304247-001

Full Powercare set

Ref. 1700343-001



POWERCARE INSERTS



S1 for scaling

Universal curette with semi-circular cross section. Recommended for the ablation of large quantities of tartar.

Power: 0 – 100%
Ref. 1304243-001



S6 for high-efficiency scaling

Universal curette in the form of a contra-angle with semi-circular diameter. Powerful insert for the ablation of large quantities of tartar.

Power: 0 – 100%
Ref. 1304244-001



S7 for high-efficiency scaling

Universal curette in the form of a contra-angle with a triangular cross section. Powerful insert efficient in interdental spaces and on surfaces.

Power: 0 – 100%
Ref. 1304245-001



S8 for high-efficiency scaling

Contra-angle with a flat working surface with rounded edges. Powerful insert for the ablation of large quantities of supragingival tartar.

Power: 0 – 100%
Ref. 1304246-001



P1 for universal periodontics

Long, straight end-piece with a circular cross section. For the ablation of calculus and biofilm on root surfaces.

Power: 0 – 50%
Ref. 1304247-001



P4 for universal periodontics

Extra-long, straight end-piece with circular cross section. For the ablation of calculus and biofilm on root surfaces.

Power: 0 – 50%
Ref. 1304248-001



P10 for anatomical periodontics

Extra-long, curved working end with circular cross section. For the ablation of calculus and biofilm on root surfaces.

Power: 0 – 50%
Ref. 1304249-001



PROPHYLAXIS INSTRUMENTS

Handpieces with interchangeable heads and contra-angles with detachable cups are the only instruments that can be fitted to motors rotating at 40,000 rpm.

Apart from superior comfort and extended service life, Bien-Air prophylaxis instruments in particular offer high resistance to abrasive cleaning pastes and can withstand constant and repeated sterilizations.

CAP 15:1 Prophy

Contra-angle handpiece without light or spray, speed reducing factor of 15, screw or clip cup interchangeability.

Pack comprising:
1 CAP 15:1 Prophy
5 screw cups
5 clip cups

Ref. 1600290-001



PMP 10:1 Prophy

Handpiece without light or spray, speed reducing factor of 10, for standard disposable heads.

Pack comprising:
1 PMP 10:1 Prophy
2 straight heads and 2 contra-angle heads

Ref. 1600289-001



AHEAD OF THE FIELD

Bien-Air has positioned itself as the world leader in electric micromotors. And this has not happened by chance. Some have even revolutionized modern dentistry practice. Power, high torque, absence of vibration and reliability... the assets that make Bien-Air micromotors so unique.

Today, Bien-Air is raising the bar even higher with the addition of a new gem to this product line: MX-LED, the most powerful implantology micromotor with constant speed under all conditions. Bien-Air is proud to offer the best performing micromotors on the market today.

Let us introduce you to the best in Swiss micro-technology.

MICROMOTORS



MX MICROMOTOR

MX is the brushless micromotor abound with superlatives. With a speed ranging from 100 to 40,000 rpm, the MX offers ultra-precise control of the torque and rotation speed thanks to Smart Logic technology. The result is impressive: irrespective of the complexity of the procedure, the speed remains constant. The motor is quiet and vibration-free. Thanks to the MX's control at low speeds, your need for instruments of differing ratios is reduced.

Just two instruments are now sufficient to cover all your needs, from endodontics to high-speed restorative dentistry. Finally, the MX micromotor and its 360° rotating coupling are notable for their exceptional reliability and extended service life. Resilient to contact with fluids, the MX withstands repeated sterilizations. Welcome to a class apart.



SMART LOGIC

The most high-precision control ever obtained with a micromotor. Cutting-edge electronics control the torque and rotation speed to perfection in addition to the bur position. Even at very low speed.



FREE MOVE

Freedom of movement for optimum working comfort. Thanks to its flexible and light rotating quick-connect coupling, the Bien-Air motor/turbine/hose combination will prove a pleasant work companion day in, day out.



GOLD CONNECT

Bien-Air equips its instruments with gold-plated electrical contacts. This results in excellent electrical conductivity and improved resistance to oxidation.



SWISS MADE

Only the most sophisticated techniques and the best materials make it possible to manufacture the best products. Bien-Air products are designed and manufactured in the heart of Watch Valley in Switzerland. After manufacture, Bien-Air products undergo individual testing.



MX Micromotor

Sterilizable without protection, with light and internal spray, Type E connection compliant with ISO 3964, quick-connect coupling rotating 360° on the 4VX hose.

Ref. 1600375-001



4VX or B4VX hose

Flexibility and lightness. Quick-connect, rotating coupling on MX motor side. See pages 126 to 127.



MX CHIROPRO MICROMOTOR

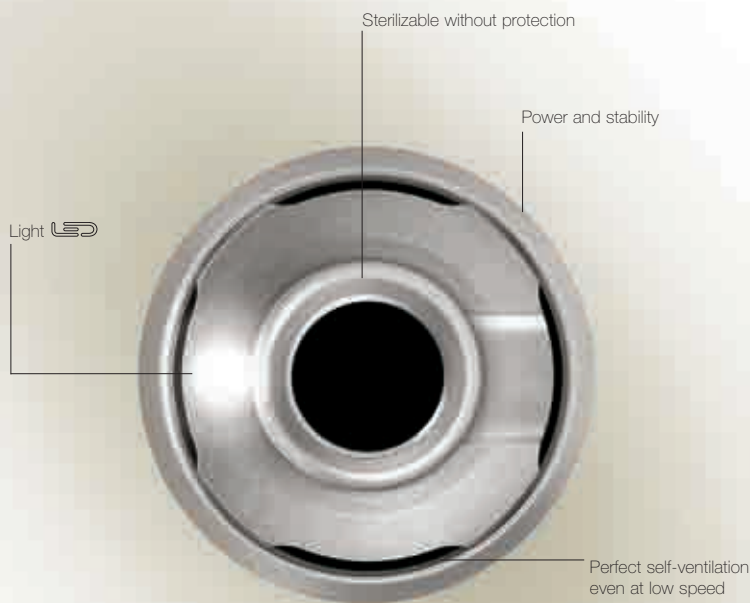

Here is the most powerful and lightweight implantology motor on the market. With its Chiropro L control unit, the MX-LED Chiropro micromotor is redefining standards in implantology. A brushless micromotor, the MX-LED Chiropro is first and foremost a model of stability. At both high and low speeds, it offers you enhanced working comfort and its high torque copes with the most demanding dental procedures. Depending on the desired speed, the power is constantly adapted in order to provide the optimum result. This is due to the Smart Logic technology. Finally, the MX-LED Chiropro micromotor is equipped with LED lighting, providing the contra-angle handpiece with intense, natural and constant light at both high and low speeds. Resilient to contact with fluids, it can be washed in a machine and sterilized with its cable.



QUALITY LED

Bien-Air is setting new standards in the field of LED lighting. Intensity-adjustable from 0 to 38,000 lux, perfectly white natural light, service life up to 10 times longer than that of a traditional bulb, no heating, exceptional resistance to sterilization.



SMART LOGIC

The most high-precision control ever obtained with a micromotor. Cutting-edge electronics control the torque and rotation speed to perfection in addition to the bur position. Even at very low speed.



GOLD CONNECT

Bien-Air equips its instruments with gold-plated electrical contacts. This results in excellent electrical conductivity and improved resistance to oxidation.



SWISS MADE

Only the most sophisticated techniques and the best materials make it possible to manufacture the best products. Bien-Air products are designed and manufactured in the heart of Watch Valley in Switzerland. After manufacture, Bien-Air products undergo individual testing.



MX Chiropro micromotor

Sterilizable without protection, with LED light, self-ventilated, Type E connection compliant with ISO 3964, power supply via special cable

Ref. 1600605-001





MX Chiropro cable

Flexibility and lightness. Sterilizable. Quick-connect coupling on control unit side. See page 135.

MX CHIROPRO MICROMOTOR THE BEST MOTOR

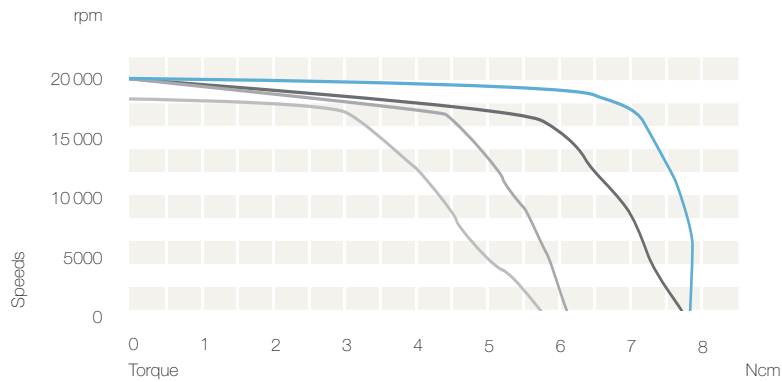
The MX-LED Chiroprpro micromotor is a model of stability. At both high and low speeds, the new MX-LED Chiroprpro offers you great working comfort. Its high torque makes it simply the most powerful motor on the market. Depending on the torque needed, the power is regulated and stabilized electronically. Accordingly, the speed is kept constant throughout the operation. Another major advantage: the motor allows LED lighting on the contra-angle handpiece with the same luminous intensity at both high and low speeds. Not only is the MX-LED Chiroprpro the most powerful motor on the market, it is also the lightest.



-  MX  Chiroprpro
-  System K
-  System N
-  System W



BASCH MICROMOTOR

The BASCH micromotor has become the benchmark in the field of implantology. High-performance, self-ventilated, it offers rotation speeds ranging from 500 to 40,000 rpm and precise speed and torque control.

It is manufactured in stainless steel to enhance resistance to physiological liquids and extends its long service life. It can be sterilized with its cable. The BASCH can be driven and configured via the Chiropro 980 control unit.



Self-ventilation

Material specially resistant to NaCl

Sterilizable without protection



GOLD CONNECT

Bien-Air equips its instruments with gold-plated electrical contacts. This results in excellent electrical conductivity and improved resistance to oxidation.



SWISS MADE

Only the most sophisticated techniques and the best materials make it possible to manufacture the best products. Bien-Air products are designed and manufactured in the heart of Watch Valley in Switzerland. After manufacture, Bien-Air products undergo individual testing.



Basch micromotor

Sterilizable, self-ventilated,
Type E coupling compliant with ISO 3964,
power supply via special cable

Ref. 1600076-001



Basch + cable set

Basch micromotor with 3 m cable,
both sterilizable.

Ref. 1700074-001



Basch cable

Sterilizable. Quick-connect coupling on control unit side.
See page 135.

MC3 MICROMOTORS

MC3 micromotors offer impressive performance. They are quite simply the most efficient brush micromotor on the market. With vibration-free operation from 20 to 40,000 rpm, their great versatility sets them apart. An outstanding motor, now also available with an intensity-adjustable LED light.



QUALITY LED

Bien-Air is setting new standards in the field of LED lighting. Intensity-adjustable from 0 to 38,000 lux, perfectly white natural light, service life up to 10 times longer than that of a traditional bulb, no heating.



FREE MOVE

Freedom of movement for optimum working comfort. Thanks to its flexible and light rotating quick-connect coupling, the Bien-Air motor/turbine/hose combination will prove a pleasant work companion day in, day out.



GOLD CONNECT

Bien-Air equips its instruments with gold-plated electrical contacts. This results in excellent electrical conductivity and improved resistance to oxidation.



SWISS MADE

Only the most sophisticated techniques and the best materials make it possible to manufacture the best products. Bien-Air products are designed and manufactured in the heart of Watch Valley in Switzerland. After manufacture, Bien-Air products undergo individual testing.

MC3 MICROMOTORS WITH LIGHT



MC3

With LED light and internal spray, detachable sleeve, Type E coupling compliant with ISO 3964

Ref. 1600680-001



MC3 MICROMOTORS WITH LIGHT



MC3 LK

With light and internal spray,
detachable sleeve, Type E coupling
compliant with ISO 3964

Ref. 1600077-001



MC3 LK + 4VR 400 hose set

MC3 LK micromotor with light, internal spray
+ 4VR 400 hose Ø 10 mm ref. 1600397-001, in grey silicone,
with coupling rotating through 400°, standard length 1.7 m

Ref. 1700046-001



MC3 LK + 4VLM hose set

MC3 LK micromotor with light and internal spray
+ 4VLM hose Ø 11 mm ref. 1600097-001, in grey silicone with
fixed coupling, standard length 1.7 m

Ref. 1700336-001



MC3 MICROMOTORS WITHOUT LIGHT



MC3 IR

Without light, internal spray,
detachable sleeve, Type E coupling
compliant with ISO 3964

Ref. 1600071-001



MC3 IR + 4VLM hose set

MC3 IR micromotor without light, internal spray
+ 4VLM hose Ø 11 mm ref. 1600097-001, in grey silicone
with fixed coupling, standard length 1.7 m

Ref. 1700337-001



4VR 400 and 4VLM hoses

are available in a range
of versions and colors.
See pages 128 to 132.

MC2 MICROMOTORS

The MC2 is the most widely used electric micromotor in the world. Appreciated and recommended for its reliability and endurance, it has been proving its worth for many years. With a rotating speed of 60 to 40,000 rpm, its performance is remarkable and it is driven highly efficiently by the PLMP 021 microprocessor control unit. The MC2 micromotor: Swiss Made design and manufacture at an attractive price. Now also available with intensity-adjustable LED light.



QUALITY LED

Bien-Air is setting new standards in the field of LED lighting. Intensity-adjustable from 0 to 38,000 lux, perfectly white natural light, service life up to 10 times longer than that of a traditional bulb, no heating.



GOLD CONNECT

Bien-Air equips its instruments with gold-plated electrical contacts. This results in excellent electrical conductivity and improved resistance to oxidation.



SWISS MADE

Only the most sophisticated techniques and the best materials make it possible to manufacture the best products. Bien-Air products are designed and manufactured in the heart of Watch Valley in Switzerland. After manufacture, Bien-Air products undergo individual testing.



MC2 MICROMOTORS WITH LIGHT



MC2 
 With LED light, internal spray,
 Type E coupling
 compliant with ISO 3964
Ref. 1600681-001



MC2 MICROMOTORS WITH AND WITHOUT LIGHT



MC2 Isolite 300
With light, internal spray,
Type E coupling compliant
with ISO 3964
Ref. 1600078-001



MC2 IR
Without light, internal spray,
Type E coupling compliant
with ISO 3964
Ref. 1600073-001



MC2 GTAV
Without light and without spray,
Type E coupling, compliant with ISO 3964,
self-ventilated
Ref. 1600075-001



Tuyau MC2
Available in a range of
versions and color.
See pages 133 to 134.



AQUILON AIR MICROMOTORS

Offering high torque at low speed, the Aquilon is a high-performance air micromotor at a very competitive price. Equipped with a ceramic stator, it is simple to maintain and has a particularly long service life. Its rotating speed ranges from 5,000 to 20,000 rpm with forward and reverse operation. It is quick to connect, thanks to its rotating Unifix quick-connect coupling.

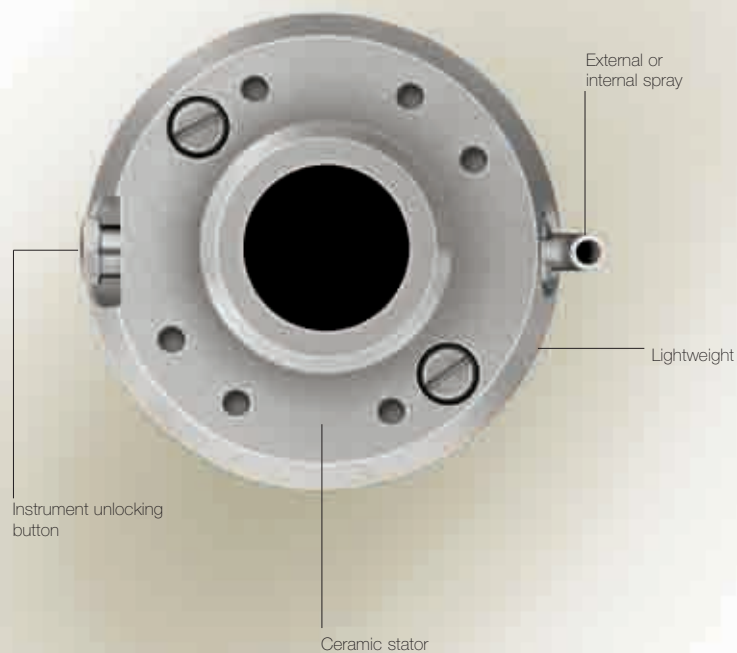

FREE MOVE

Freedom of movement for optimum working comfort. Thanks to its flexible and light rotating quick-connect coupling, the Bien-Air motor/turbine/hose combination will prove a pleasant work companion day in, day out.



SWISS MADE

Only the most sophisticated techniques and the best materials make it possible to manufacture the best products. Bien-Air products are designed and manufactured in the heart of Watch Valley in Switzerland. After manufacture, Bien-Air products undergo individual testing.

AQUILON AIR MICROMOTOR INTERNAL SPRAY



Aquilon 830

Internal spray, Type E coupling compliant with ISO 3964, quick-connect rotating connection for 3- or 4-way Unifix coupling

Ref. 1600070-001





Aquilon 830 + 3-way Unifix set

Micromotor with internal spray, Type E coupling compliant with ISO 3964, quick-connect rotating connection with 3-way Unifix coupling

Ref. 1700058-001



Aquilon 830 + 4-way Unifix set

Micromotor with internal spray, Type E coupling compliant with ISO 3964, quick-connect rotating connection, with 4-way Unifix coupling

Ref. 1700211-001



**AQUILON AIR MICROMOTOR
EXTERNAL SPRAY**



Aquilon 830 external spray

External spray, Type E coupling compliant with ISO 3964, quick-connect rotating connection for 3- or 4-way Unifix coupling

Ref. 1600362-001



THE VERY BEST MOTORS DEMAND THE BEST PERFORMING CONTROL UNITS

What is the point of having a powerful motor without the right control unit to drive it? A micromotor's precision, power and service life depend directly on the quality of its electronic control unit. To drive its range of motors, Bien-Air has designed control units which manage the necessary power, drive the motors linearly and without vibration, while at the same time offering the requisite operating ranges. Providing the ultimate speed and torque control, the latest generation control units with Smart Logic technology are capable of exploiting to the full the outstanding capacities of the MX and MX-LED motors. More than ever before, you have the very best tools at your fingertips.

CONTROL UNITS FOR MICROMOTORS



OPTIMA MX^{INT} & DMX



Multilingual display offering excellent readability

Many pre-programmed sequences for endodontics and restoration work

EASY-NAV simplified navigation

Reduced dimensions

Easy maintenance

MX is the motor of superlatives. To drive it, Bien-Air has designed a control unit which matches its performance. The Optima MX^{INT} control unit and its micromotor guarantee absolute control of the bur, controlling speed, torque and automatic reversal of the direction of rotation. The Optima MX^{INT} is particularly versatile. This control unit offers pre-programmed modes for all the main restorative operations and for endodontics. A true all-in-one system, it also makes your life simpler: two contra-angle handpieces are sufficient to perform the vast majority of dentistry operations. This results in improved comfort as well as a time saving. Thanks to its Easy-Nav philosophy, the Optima MX^{INT} is incredibly intuitive and adapts to most of dental chairs. It is ideal if you want to upgrade your pneumatic chair to bring it into the electronic age. Quite simply, it offers the best Swiss engineering.



SMART LOGIC
The most high-precision control ever obtained with a micromotor. Cutting-edge electronics control the torque and rotation speed to perfection in addition to the bur position. Even at very low speed.



EASY-NAV
Intuitive, simple, user-friendly navigation. You'll love working fast, logically and with assistance. Straightforward. EASY-NAV. The professional interface.



GOLD CONNECT
Bien-Air equips its instruments with gold-plated electrical contacts. This results in excellent electrical conductivity and improved resistance to oxidation.



SWISS MADE
Only the most sophisticated techniques and the best materials make it possible to manufacture the best products. Bien-Air products are designed and manufactured in the heart of Watch Valley in Switzerland. After manufacture, Bien-Air products undergo individual testing.



OPTIMA MX^{INT} ONE SYSTEM AND TWO INSTRUMENTS FOR ALL YOUR DENTISTRY WORK

Thanks to the unique performance of the combination of motors and Optima MX, Optima MX^{INT} and DMX control units, no more than two contra-angle handpieces are now needed for the majority of dental restoration, prophylaxis or endodontic work, including procedures using NiTi tools.

With the CA 1:1 and CA 1:5, you have at your disposal a range of speeds from 100 rpm to 200,000 rpm. This remarkable advance reduces the number of instruments needed in the dental operatory.



EXAMPLES OF OPERATIONS POSSIBLE WITH TWO BIEN-AIR CONTRA-ANGLE HANDPIECES



Table of current possible applications

Applications and contra-angle handpieces	CA 1:5	CA 1:1
Minimum speed in rpm	500	100
Maximum speed in rpm	200 000	40 000
Amalgam polishing		•
Root treatment - NiTi		•
Removal of deep caries		•
Removal of caries	•	•
Hole drilling		•
Preparation of temporary crowns and bridges		•
Gold and microwire polishing	•	•
Interdental and subgingival polishing		•
Surplus amalgam removal	•	•
MC Spadden endodontic technique		•
Chrome cobalt balance		•
General finishing in cavity preparation		•
Cutting of retentive grooves	•	•
Ceramic adjustment	•	
Finishing preparation B+C, bevels and ridges	•	•
Finishing preparation B+C, cavities, bevels and ridges		•
Occlusal adjustment	•	
Dentine reduction	•	•

This table shows possible uses and does not in any way constitute recommendations for use.

OPTIMA MX^{INT} - WITH ENDODONTIC FUNCTIONS
 INTEGRATABLE SYSTEM WITH REMOTE CONTROL UNIT



- Broad speed range of the MX micromotor:
from 100 to 40,000 rpm
- High speed mode for general operations
- Low speed mode for endodontics with NiTi tools:
automatic reversal of the direction of rotation when
speed is at 0, automatic return to clockwise movement
(adjustable timing)
- Easy navigation system
- Major functions modifiable at all times:
 - Selection of one of the 40 programs
 - Actual instrument speed
 - Variable torque
 - Handpiece ratio
 - With or without lighting
 - Light intensity
 - Choice of 5 languages

Optima MX^{INT} set with DMX Standard kit:

1 Optima MX ^{INT} control unit	ref. 1600534-001
1 sterilizable MX micromotor	ref. 1600375-001
1 4VX hose for MX micromotor	ref. 1600387-001
1 DMX Standard electronic control unit	ref. 1600472-001

Supplied with bracket and mounting screws,
 16-pole cable

Complete set for 1 MX micromotor

Ref. 1700258-001

Basic set ref. 1700258-001 also including:

1 80-240 Vac transformer,
 with 5-meter 32 Vdc cable ref.1600591-001
 Complete set for 1 MX micromotor

Ref. 1700270-001

Basic set ref. 1700258-001 also including:

1 converter, 24 Vac/32 Vdc - 24 Vdc ref. 1500580-001
 Complete set for 1 MX micromotor

Ref. 1700275-001

Basic set ref. 1700258-001 also including:

1 sterilizable MX micromotor ref. 1600375-001
 1 4VX hose for MX micromotor ref. 1600387-001
 1 PL DMS relay ref. 1500554-001
 1 converter, 24 Vac/32 Vdc - 24 Vdc ref. 1500580-001
 Complete set for 2 MX micromotors

Ref. 1700259-001

OPTIMA MX^{INT} - WITHOUT ENDODONTIC FUNCTION
INTEGRATABLE SYSTEM WITH REMOTE CONTROL UNIT



This version of the OPTIMA MX^{INT} with DMX Basic (electronic) offers the same advantages as the DMX Standard, except for endodontic procedures with automatic reversal of the direction of rotation and without torque adjustment. It ensures absolute control of the sterilizable, brushless MX micromotor, from 100 to 40,000 rpm.

Optima MX^{INT} set with DMX Basic kit:

1 Optima MX ^{INT} control unit	ref. 1600534-001
1 sterilizable MX micromotor	ref. 1600375-001
1 4VX hose for MX micromotor	ref. 1600387-001
1 DMX Basic electronic control unit	ref. 1600473-001

Supplied with bracket and mounting screws,
16-pole cable
Complete set for 1 MX micromotor

Ref. 1700260-001

Basic set ref. 1700260-001 also including:

1 80-240 Vac transformer, with 5-meter 32 Vdc cable	ref. 1600591-001
--	------------------

Complete set for 1 MX micromotor

Ref. 1700271-001



**DMX STANDARD - WITH ENDODONTIC FUNCTIONS
INTEGRATABLE SYSTEM, WITHOUT CONTROL UNIT**

With DMX Standard, it's the control system for your unit which controls the MX micromotor. Your distributor-installer is able to upgrade your electric or air-powered unit to the leading MX technology. You can thus have a high-performance instrument with your unit's customary control system.



DMX Standard set:

- | | |
|--|------------------|
| 1 DMX Standard electronic control unit | ref. 1600472-001 |
| 1 sterilizable MX micromotor | ref. 1600375-001 |
| 1 4VX hose for MX micromotor | ref. 1600387-001 |
| 1 converter, 24 Vac/32 Vdc - 24 Vdc | ref. 1500580-001 |
| Complete set for 1 MX micromotor | |
| Ref. 1700230-001 | |

DMX Standard set without converter:

- | | |
|--|------------------|
| 1 DMX Standard electronic control unit | ref. 1600472-001 |
| 1 sterilizable MX micromotor | ref. 1600375-001 |
| 1 4VX hose for MX micromotor | ref. 1600387-001 |
| Complete set for 1 MX micromotor | |
| Ref. 1700241-001 | |

DMX Standard set with 2 MX micromotors:

- | | |
|--|------------------|
| 1 DMX Standard electronic control unit | ref. 1600472-001 |
| 2 sterilizable MX micromotors | ref. 1600375-001 |
| 2 4VX hoses for MX micromotor | ref. 1600387-001 |
| 1 PL DMS relay | ref. 1500554-001 |
| 1 converter, 24 Vac/32 Vdc - 24 Vdc | ref. 1500580-001 |
| Complete set for 2 MX micromotors | |
| Ref. 1700232-001 | |

**DMX BASIC - WITHOUT ENDODONTIC FUNCTION
INTEGRATABLE SYSTEM, WITHOUT CONTROL UNIT**

This simplified version, without torque control, offers the same advantages as the DMX Standard version, except for endodontic procedures. It guarantees absolute control of the sterilizable brushless MX micromotor from 100 to 40,000 rpm. DMX Standard and Basic are 100% Swiss Made electronic technologies.



DMX Basic set:

- | | |
|-------------------------------------|------------------|
| 1 DMX Basic electronic control unit | ref. 1600473-001 |
| 1 sterilizable MX micromotor | ref. 1600375-001 |
| 1 4VX hose for MX micromotor | ref. 1600387-001 |
| 1 converter, 24 Vac/32 Vdc - 24 Vdc | ref. 1500580-001 |
| Complete set for 1 MX micromotor | |
| Ref. 1700231-001 | |

DMX Basic set without converter:

- | | |
|-------------------------------------|------------------|
| 1 DMX Basic electronic control unit | ref. 1600473-001 |
| 1 sterilizable MX micromotor | ref. 1600375-001 |
| 1 4VX hose for MX micromotor | ref. 1600387-001 |
| Complete set for 1 MX micromotor | |
| Ref. 1700245-001 | |

DMX Basic set with 2 MX micromotors:

- | | |
|-------------------------------------|------------------|
| 1 DMX Basic electronic control unit | ref. 1600473-001 |
| 2 sterilizable MX micromotors | ref. 1600375-001 |
| 2 4VX hoses for MX micromotor | ref. 1600387-001 |
| 1 PL DMS relay | ref. 1500554-001 |
| 1 converter, 24 Vac/32 Vdc - 24 Vdc | ref. 1500580-001 |
| Complete set for 2 MX micromotors | |
| Ref. 1700233-001 | |

OPTIMA MX WITH ENDODONTIC FUNCTIONS
COMPLETE EXTERNAL TABLETOP SYSTEM



Click & Work

OPTIMA MX ensures absolute control of the sterilizable, brushless MX micromotor. This innovative concept allows most operations, including endodontics with NiTi tools, to be covered with just 2 contra-angles. The OPTIMA MX offers perfect speed and torque control and auto reverse. Its touchscreen display is easy to use and the 5 programs may be customized. Speeds from 100 to 200,000 rpm with CA 1:1 and CA 1:5 ratios. The speed is adjusted with the existing pedal. The MX motor is fitted with a quick-connect rotating coupling. The OPTIMA MX can be installed quickly and is directly operational via simple connection to a 4-way hose.

Optima MX set:

1 Optima MX control unit	ref. 1600459 - 001
1 80 to 240 Vac transformer	ref. 1600596 - 001
1 stylus	ref. 1300134 - 001
1 B4VX hose with quick-connect coupling	ref. 1600428 - 001
1 MX micromotor, sterilizable	ref. 1600375 - 001
Complete set for 1 micromotor	
Ref. 1700047-001	

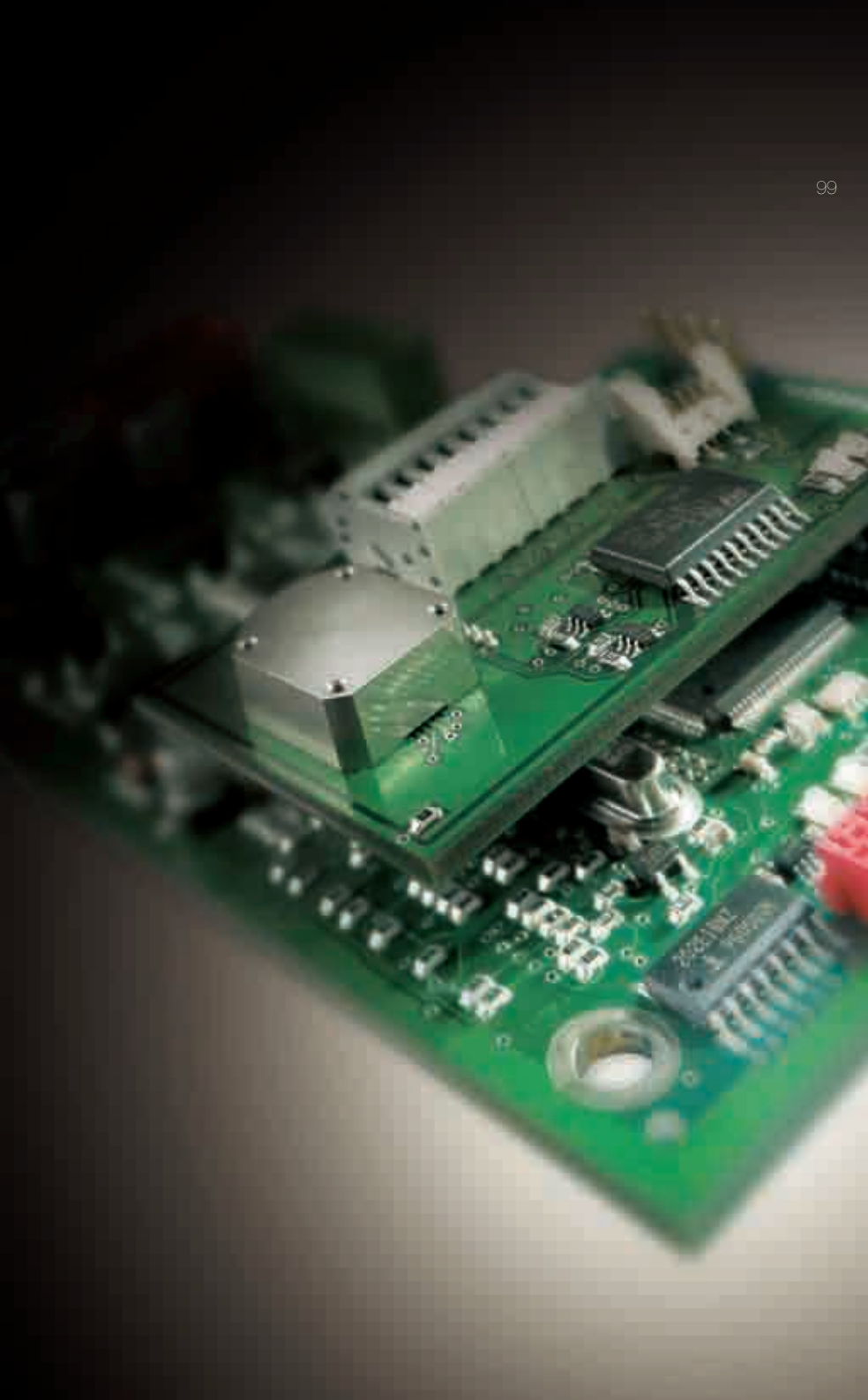

PLMP 021 CONTROL UNIT

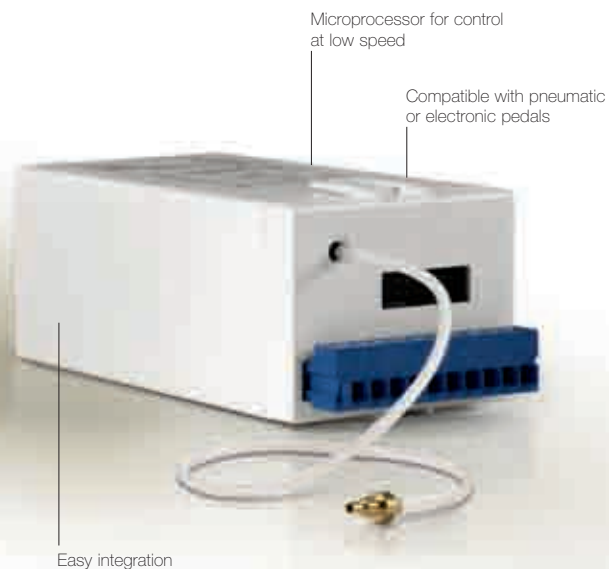

The PLMP 021 control unit is specially designed for MC3 and MC2 micromotors. Incorporating an electronically or pneumatically-driven microprocessor, it manages a particularly wide range of speeds, from 20 to 40,000 rpm.

Thanks to this control, the micromotors rotate without vibration or jolting from the lowest to the highest speeds in both directions of rotation and with a high torque, particularly at low speed.

The PLMP 021's major advantage is the unit's small dimensions.

This means it is easy to integrate into all electronic or pneumatic units.



GOLD CONNECT

Bien-Air equips its instruments with gold-plated electrical contacts. This results in excellent electrical conductivity and improved resistance to oxidation.



SWISS MADE

Only the most sophisticated techniques and the best materials make it possible to manufacture the best products. Bien-Air products are designed and manufactured in the heart of Watch Valley in Switzerland. After manufacture, Bien-Air products undergo individual testing.



PLMP 021 kit

1 PLMP 021 microprocessor control unit ref. 1600350-001.
Supplied with 18 meters of electric wire, potentiometer, solenoid valve, switch, adhesive sticker and flanges for fixing to the unit
Ref. 1600351-001

PLMP 021

Control unit only
Ref. 1600350-001



TO MEET THE HIGHEST REQUIREMENTS

Implantology is a demanding discipline. To offer you maximum comfort and to guarantee that of your patients, Bien-Air has created high-performance systems which leave nothing to chance. After the Chiropro 980, which has proved its worth in countless dental surgeries, Bien-Air now presents the Chiropro L, an incredible system offering versatility, comfort and performance. Combined with exceptional instruments and motors, Bien-Air implantology systems represent a benchmark. Try them. You'll never look back.

IMPLANTOLOGY SYSTEMS



CHIROPRO L



Bien-Air's latest arrival, the Chiropro L is an ultra-efficient and multi-function implantology system, designed for many clinical applications such as implantology, dental surgery and endodontics. With the Chiropro L, everything is designed for your comfort. The MX-LED Chiropro micromotor, the most powerful and lightweight on the market, has LED lighting of equal intensity whether at high or low speeds. The contra-angle incorporates a unique irrigation system which is internal to the instrument, offering ideal grip. The Chiropro L also offers 7 of the main implant systems on the market with their complete sequences*. It can also be customized according to your needs. With the Chiropro L, reassess your requirements.

* Not available in the US version



QUALITY LED

Bien-Air is setting new standards in the field of LED lighting. Adjustable intensity from 0 to 38,000 lux, perfectly white natural light, service life up to 10 times longer than that of a traditional bulb, no overheating, exceptional resistance during sterilization.



DUALOOK

In addition to being rugged under all conditions, the two glass fiber rods give an enveloping, non-dazzling light, clearly showing depth. DUALOOK: the best lighting on the market.



ACCU-CHUCK

The most precise bur locking and rotation drive technology in the world. Discover instruments with perfect equilibrium, free from any imbalance or vibration. The best of Swiss technology.



SMART LOGIC

The most high-precision control ever obtained with a micromotor. Cutting-edge electronics control the torque and rotation speed to perfection in addition to the bur position. Even at very low speed.



EASY-NAV

Intuitive, simple, user-friendly navigation. You'll love working fast, logically and with assistance. Straightforward. EASY-NAV. The professional interface.



GOLD CONNECT

Bien-Air equips its instruments with gold-plated electrical contacts. This results in excellent electrical conductivity and improved resistance to oxidation.



SWISS MADE

Only the most sophisticated techniques and the best materials make it possible to manufacture the best products. Bien-Air products are designed and manufactured in the heart of Watch Valley in Switzerland. After manufacture, Bien-Air products undergo individual testing.

CHIROPRO L TO MEET THE HIGHEST REQUIREMENTS.



The Chiropro L incorporates 7 of the leading implant systems on the market with their complete sequences*.

The Chiropro L can also be customized according to your needs.

From preparation of the implant site to implant fastening, the pre-programmed clinical sequence is displayed on screen. Only a few seconds are needed to define, save or modify your program.

Designed to simplify your daily practice, the Chiropro L unit is infinitely versatile, allowing numerous clinical applications such as implantology, endodontics and dental surgery.



Bien-Air has designed a new patented peristaltic pump. The single-use irrigation lines incorporate an insertion support ensuring very easy handling and optimum hygiene.

The Chiropro L is pre-programmed for the following implant systems*:

- Straumann
- Nobel Biocare
- Zimmer
- Dentsply-Friadent
- Biomet 3i
- AstraTech
- Thommen Medical
- Système libre

* Not available in the US version



* Not available in the US version

Straumann, Nobel Biocare, Zimmer, Dentsply-Friadent, Biomet 3i, AstraTech, and Thommen Medical are trademarks registered by the corresponding companies. The parameters contained in the implant manufacturers' programs are given for information only and Bien-Air cannot be held liable for them. The parameters may be subject to modification without notice.

**CHIROPRO L - IMPLANTOLOGY DEVICE
FOR INSTRUMENTS WITH OR WITHOUT LIGHT**



Chiropro L basic kit:

1 Chiropro L control unit	ref. 1600613 - 001
1 MX-LED Chiropro micromotor	ref. 1600605 - 001
1 MX-LED Chiropro micromotor cable	ref. 1600606 - 001
1 3-button foot pedal	ref. 1600631 - 001
10 sterile single-use irrigation lines	ref. 1500984 - 010
10 irrigation line fixing brackets	ref. 1303711 - 010
1 bracket	ref. 1303393 - 001
1 holder	ref. 1301575 - 001
1 network cable CH	ref. 1300065 - 001
1 network cable Europe	ref. 1300066 - 001
1 network cable Asia/USA	ref. 1300067 - 001

Ref. 1700298-001

Chiropro L basic kit USA

(USA version control unit ref. 1600679-001)

Ref. 1700349-001

Chiropro L basic kit with CA 20:1 L contra-angle

1 Chiropro L basic kit	ref. 1700298 - 001
1 CA 20:1 L contra-angle with light	ref. 1600598 - 001

Ref. 1700307-001



Chiropro L basic kit USA with CA 20:1 L contra-angle

1 Chiropro L basic kit USA	ref. 1700349 - 001
1 CA 20:1 L contra-angle with light	ref. 1600598 - 001

Ref. 1700350-001



CHIROPRO L ACCESSORIES



CA 20:1 L

Internal irrigation, light via optical glass rod, speed reducing ratio of 20, push-button bur locking, bur shank Ø 2.35 mm

Ref. 1600598-001



Irrigation lines

Set of 10 single-use irrigation lines, with a flow rate of 30 to 150 ml/min

Ref. 1500984-010



Irrigation line fixing clips

Set of 10 fixing clips for Chiropro L irrigation line

Ref. 1303711-010



Aquacare

Cleaning spray 500 ml. Box of 6. Cleaning product for instruments used with physiological liquid

Ref. 1600617-006



Maintenance Triopack

Only available from your local distributor.

CHIROPRO 980

The Chiropro 980 is a powerful implantology system, capable of driving two motors. The Chiropro is particularly reliable and resistant: it has a robust design. This means it meets the most stringent international safety standards. With a large backlit display, available in seven languages, and intuitive programming, the Chiropro is extremely easy to use in practice. Eight programs are available and can be modified, even during use. You also have a selection of 31 handpiece ratios. The peristaltic pump delivery is adjustable from 15 to 130 ml/min.



GOLD CONNECT

Bien-Air equips its instruments with gold-plated electrical contacts. This results in excellent electrical conductivity and improved resistance to oxidation.



SWISS MADE

Only the most sophisticated techniques and the best materials make it possible to manufacture the best products. Bien-Air products are designed and manufactured in the heart of Watch Valley in Switzerland. After manufacture, Bien-Air products undergo individual testing.



**CHIROPRO 980 - IMPLANTOLOGY DEVICE
FOR INSTRUMENTS WITHOUT LIGHT**



Chiropro 980 basic kit:

1 Basch micromotor	ref. 1600076 - 001
1 black cable for Basch micromotor	ref. 1600342 - 001
1 multifunction foot pedal, 2 buttons	ref. 1600281 - 001
1 integral peristaltic pump	
1 bracket	ref. 1500017 - 001
10 irrigation lines, choice of 2 flow rates	ref. 1100037 - 010
10 fixing clips	ref. 1300064 - 010
1 holder	ref. 1301575 - 001

Chiropro 980 basic kit for 230 Vac with:

1 control unit	ref. 1600238 - 001
1 network cable Switzerland	ref. 1300065 - 001
1 network cable Europe	ref. 1300066 - 001

Ref. 1700113-001

Chiropro 980 basic kit for 115 Vac with:

1 control unit	ref. 1600241 - 001
1 network cable US/113	ref. 1300067 - 001

Ref. 1700114-001

Chiropro 980 basic kit for 100 Vac with:

1 control unit	ref. 1600240 - 001
1 network cable US/113	ref. 1300067 - 001

Ref. 1700115-001

CHIROPRO 980 ACCESSORIES



CA 20:1

Contra-angle with internal irrigation, without light, speed reducing ratio of 20, push-button bur locking, bur shank Ø 2.35 mm

Ref. 1600632-001



Irrigation lines

Set of 10 single-use irrigation lines with a choice of two flow rate ranges according to the hose diameter: from 30 to 130 ml/min with the white silicon hose or from 15 to 65 ml/min with the green silicon hose

Ref. 1100037-010



Irrigation line fixing clips

Set of 10 fixing clips for Chiropro 980 irrigation line

Ref. 1300064-010



Basch + cable set

Basch micromotor with 3 m cable, both sterilizable.

Ref. 1700074-001



Maintenance Triopack

Only available from your local distributor.

IMPLANTOLOGY INSTRUMENTS

Thanks to the outstanding ergonomic design of the new Bien-Air 20:1 L implantology contra-angle, the word «comfort» takes on a whole new meaning. This contra-angle has an irrigation system which is internal to the instrument – a world first. So your grip is not impeded by the irrigation line. The jet of physiological liquid is projected onto the drill shaft itself, providing perfect cooling, particularly when using implant guides for insertions. The CA 20:1 has a miniature head and is the lightest on the market. In addition, its shafts and gears are machined in stainless steel with high resistance to saline solutions. The PM 1:2 straight handpiece is ideal for wisdom tooth extraction. It has been designed to withstand the considerable stresses resulting from repeated lateral pressure, while maintaining exceptional precision. A tooth can be cut rapidly and the temperature generated on contact remains low. Speed, comfort and precision are assured.



DUALOOK

In addition to being rugged under all conditions, the two glass fiber rods give an enveloping, non-dazzling light, clearly showing depth. DUALOOK: the best lighting on the market.



ACCU-CHUCK

The most precise bur locking and rotation drive technology in the world. Discover instruments with perfect equilibrium, free from any imbalance or vibration. The best of Swiss technology.



SOFT PUSH

Bien-Air's unique push-button insert locking mechanism. Light pressure is all that is needed. Bur changing is quick and comfortable. This mechanism guarantees firm yet precise locking.



IDEAL GEOMETRY

Improved accessibility to areas at the rear of the mouth. Bien-Air contra-angles are designed to offer you improved handling, visibility and accessibility to the working area.



SWISS MADE

Only the most sophisticated techniques and the best materials make it possible to manufacture the best products. Bien-Air products are designed and manufactured in the heart of Watch Valley in Switzerland. After manufacture, Bien-Air products undergo individual testing.

20:1 CONTRA-ANGLES WITH INTERNAL IRRIGATION



CA 20:1 L

Internal irrigation, light via optical glass rod,
speed reducing ratio of 20, push-button bur locking,
bur shank \varnothing 2.35 mm

Ref. 1600598-001



CA 20:1

Internal irrigation, without light,
speed reducing ratio of 20, push-button bur locking,
bur shank \varnothing 2.35 mm

Ref. 1600632-001



**CONTRA-ANGLES
WITH DETACHABLE IRRIGATION TUBE**



CA 1:1
Detachable external irrigation, direct ratio, without light, push-button bur locking, bur shank Ø 2.35 mm. Irrigation set included ref. 1500431-010
Ref. 1600200-001



CA 30:1
Detachable external irrigation, speed reducing ratio of 30, without light, push-button bur locking, bur shank Ø 2.35 mm. With Kirschner/Meyer detachable irrigation system. Irrigation set included ref. 1500467-010
Ref. 1600284-001



**CONTRA-ANGLES
WITH FIXED EXTERNAL IRRIGATION TUBE**



CA 1122
Fixed external irrigation, direct ratio, without light, push-button bur locking, bur shank Ø 2.35 mm. Fixed side irrigation tube
Ref. 1600603-001



CA 30121
Fixed external irrigation, speed reducing ratio of 30, without light, push-button bur locking, bur shank Ø 2.35 mm. With Kirschner/Meyer detachable irrigation system. Irrigation set included ref. 1500028-001
Ref. 1600479-001



**STRAIGHT HANDPIECES
WITH EXTERNAL IRRIGATION TUBE**



PM 1:1
External irrigation, without light, direct ratio, interchangeable sleeves with or without irrigation tube, locking ring, bur shank Ø 2.35 mm
Ref. 1600052-001



PM 1:2
External irrigation, without light, x2 multiplier, interchangeable sleeves with or without irrigation tube, locking ring, bur shank Ø 2.35 mm
Ref. 1600436-001



Examples of clinical applications in implantology	CA 1:1	PM 1:1	PM 1:2	CA 20:1	CA 30:1	Speed ranges (rpm)
Smoothing of the alveolar crest	•	•	•			40,000 - 80,000
Implant site marking (ball bur)	•	•		•		2000/2500 - 40,000
Drilling				•	•	500 - 1,000
Tapping				•	•	5 - 30
Implant tightening				•	•	5 - 30
Prosthetic screw tightening				•	•	5 - 30
Osteotomy		•	•			40,000 - 80,000
Bone graft		•	•			40,000 - 80,000
Wisdom tooth extraction		•	•			40,000 - 80,000

This table shows possible uses and does not in any way constitute recommendations for use. They apply to handpieces equipped with an irrigation system for physiological liquid.

SMOOTH AND EASY INSTRUMENT CHANGING

In your daily practice, you demand maximum comfort. To offer you this level of comfort, Bien-Air has thought of everything, right down to the very last detail. Accessories are no exception to this rule.

Our couplings and hoses are designed to allow you to work effortlessly with complete freedom. They are suitable for a large number of instruments, which can be interchanged in no time at all. What's more, every Bien-Air hose is individually tested in order to guarantee the very best performances. Comfort and reliability.

COUPLINGS AND HOSES



QUICK-CONNECT COUPLINGS



Whether Unifix or bayonet, the reliability, ease of use, lightness and durability of the Bien-Air three or four-way quick-connect couplings really sets them apart. Their ability to rotate leaves the practitioner free to work without constraints. Fitted with a quick-connect connection and an easy-to-use secure release, they can be fitted and removed in no time at all.



FREE MOVE

Freedom of movement for optimum working comfort. Thanks to its flexible and light rotating quick-connect coupling, the Bien-Air motor/turbine/hose combination will prove a pleasant work companion day in, day out.



GOLD CONNECT

Bien-Air equips its instruments with gold-plated electrical contacts. This results in excellent electrical conductivity and improved resistance to oxidation.



SWISS MADE

Only the most sophisticated techniques and the best materials make it possible to manufacture the best products. Bien-Air products are designed and manufactured in the heart of Watch Valley in Switzerland. After manufacture, Bien-Air products undergo individual testing.

UNIFIX COUPLINGS FOR INSTRUMENTS WITH LIGHT



4-way Unifix coupling

4-way quick-connect coupling, for instruments with light, with air non-return valve

Ref. 1600363-001



4-way Unifix coupling

4-way quick-connect couplings for instruments with light, with a valve for regulating spray

Ref. 1600086-001



UNIFIX COUPLINGS FOR INSTRUMENTS WITHOUT LIGHT



4-way Unifix coupling

4-way quick-connect coupling, for instruments without light

Ref. 1600082-001



3-way Unifix coupling

3-way quick-connect coupling, for instruments without light

Ref. 1600081-001



Non-sterilizable couplings.

QUICK-CONNECT COUPLINGS FOR EOLIA B TURBINES

Quick-connect connection by means of the new metal bayonet coupling, available in 2-3 way and 4-way versions with anti-retraction valve. Can be connected to 2- and 3-way hoses, without light, or 4-way with or without light. Eolia B couplings cannot be sterilized.

125



Eolia B 4-way quick-connect coupling

Eolia B 4-way quick-connect coupling with water anti-retraction system, new generation

Ref. 1600648-001



Eolia B 2-3 way quick-connect coupling

Eolia B quick-connect coupling, 2-3 holes, new generation

Ref. 1600647-001



2- AND 3-WAY OUTLET ADAPTERS

Adapter

For Bien-Air turbines and air micromotors with 2- or 3-way connection for 4-way hose

Ref. 1600089-001



Non-sterilizable couplings.

4VX HOSES FOR MX MICROMOTOR

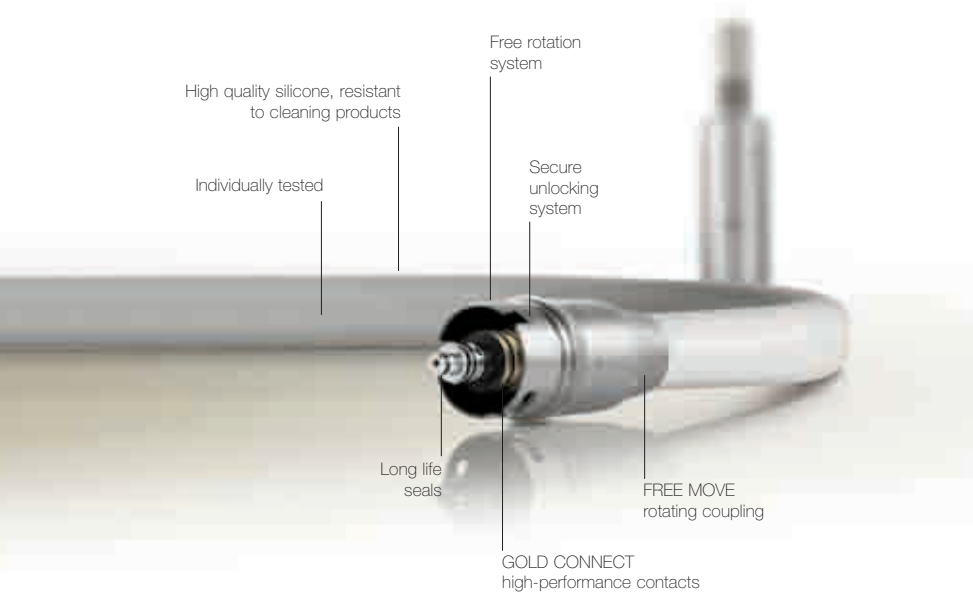

An exceptional hose for an exceptional motor: the 4VX hose is the indispensable complement to the MX micromotor. Manufactured from very high-quality materials, it is extremely resistant and flexible. In addition, it is available up to a length of 3 meters. The connection to the motor rotates from 360° by means of a patented bayonet quick-connect coupling, leaving you unprecedented freedom of movement. Every hose is assembled by hand and is individually tested.



FREE MOVE

Freedom of movement for optimum working comfort. Thanks to its flexible and light rotating quick-connect coupling, the Bien-Air motor/turbine/hose combination will prove a pleasant work companion day in, day out.



GOLD CONNECT

Bien-Air equips its instruments with gold-plated electrical contacts. This results in excellent electrical conductivity and improved resistance to oxidation.



SWISS MADE

Only the most sophisticated techniques and the best materials make it possible to manufacture the best products. Bien-Air products are designed and manufactured in the heart of Watch Valley in Switzerland. After manufacture, Bien-Air products undergo individual testing.



4VX hoses for MX micromotor

With built-in quick-connect rotating coupling, Ø 10 mm hose in grey silicone, standard length 1.7 m

Ref. 1600387-001

Ref. 1600387-0 special length



B4VX hose for MX micromotor

With built-in quick-connect rotating coupling, bayonet connector on unit side, Ø 10 mm hose in grey silicone, standard length 1.7 m

Ref. 1600428-001

Ref. 1600428-0 special length



Bayonet connector for B4VX

Coupling on unit side, for Ø 18 mm way and anti-rotation slot, standard length 60 cm

Ref. 1600278-001

Ref. 1600278-0 special length

4VR 400 HOSES FOR MC3 MICROMOTORS

The 4VR 400 hose is specially designed for MC3 micromotors. Manufactured in very high-quality materials, it is extremely resistant and flexible. In addition, it is available up to a length of 3 meters. Lightweight and fitted with a rotating coupling, it guarantees easy use of your instruments, with or without light. Every hose is assembled by hand and is individually tested.



FREE MOVE

Freedom of movement for optimum working comfort. Thanks to its flexible and light rotating quick-connect coupling, the Bien-Air motor/turbine/hose combination will prove a pleasant work companion day in, day out.



GOLD CONNECT

Bien-Air equips its instruments with gold-plated electrical contacts. This results in excellent electrical conductivity and improved resistance to oxidation.



SWISS MADE

Only the most sophisticated techniques and the best materials make it possible to manufacture the best products. Bien-Air products are designed and manufactured in the heart of Watch Valley in Switzerland. After manufacture, Bien-Air products undergo individual testing.

4VR 400 hose for MC3 micromotor

With coupling rotating through 400°, Ø 10 mm hose in grey silicone, standard length 1.7 m

Ref. 1600397-001

Ref. 1600397-0 special length



B4VR 400 hose for MC3 micromotor

With coupling rotating through 400°, bayonet connector on unit side, Ø 10 mm hose in grey silicone, standard length 1.7 m

Ref. 1600398-001

Ref. 1600398-0 special length



B4VR 400 hose pack for MC3 micromotor

Complete hose ref. 1600398-001 with bayonet connector for unit, Ø 18 mm way and anti-rotation slot, standard length 60 cm ref. 1600280-001

Ref. 1700043-001



HOSES FOR TURBINES AND MC2, MC3, BASCH, MX-LED MICROMOTORS

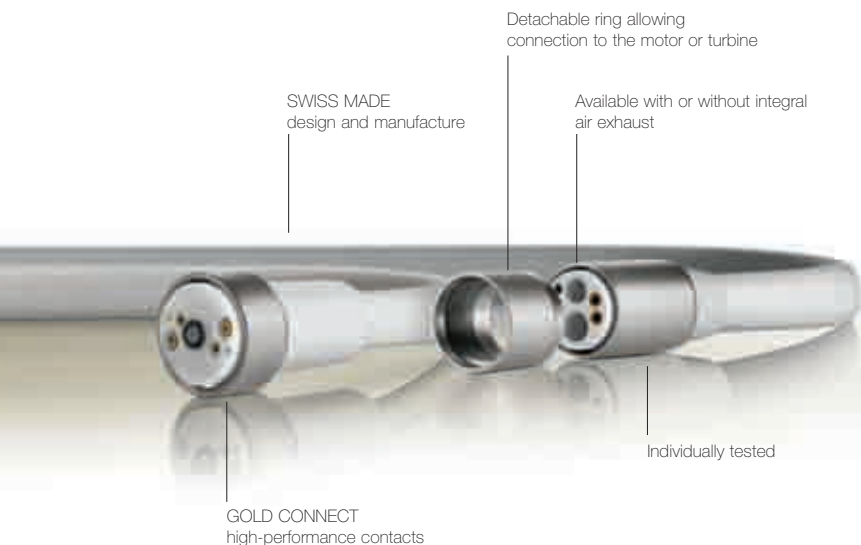

Whether fitted with an air exhaust, whether intended to function with or without light, or whether or not they are sterilizable, our hoses for turbines and MC2, MC3, BASCH and MX-LED micromotors offer all the qualities you expect from 100% Swiss Made products. They are manufactured from very high-quality materials and are extremely resistant and flexible. Every hose is assembled by hand and is individually tested. A guarantee of quality and unfailing reliability.



FREE MOVE

Freedom of movement for optimum working comfort. Thanks to its flexible and light rotating quick-connect coupling, the Bien-Air motor/turbine/hose combination will prove a pleasant work companion day in, day out.



GOLD CONNECT

Bien-Air equips its instruments with gold-plated electrical contacts. This results in excellent electrical conductivity and improved resistance to oxidation.



SWISS MADE

Only the most sophisticated techniques and the best materials make it possible to manufacture the best products. Bien-Air products are designed and manufactured in the heart of Watch Valley in Switzerland. After manufacture, Bien-Air products undergo individual testing.

4VLM HOSES WITH INTEGRAL AIR EXHAUST FOR TURBINES, MC3 AND AQUILON MICROMOTORS

The 4VLM hose is suitable for turbines, Aquilon air micromotors and MC3 electric micromotors, with or without light. Fitted with a fixed coupling and air exhaust, this Swiss Made hose is manufactured from high-quality materials which ensure flexibility and long service life. Lengths of up to 3 m available.



4VLM multi-purpose hose, grey

With 4-way coupling with electrical socket, integral air exhaust, Ø 11 mm hose in grey silicone, standard length 1.7 m

Ref. 1600097-001

Ref. 1600097-0 special length



4VLM multi-purpose hose, black

With 4-way coupling with electrical socket, air exhaust, Ø 11 mm hose in black silicone, standard length 1.7 m

Ref. 1600098-001

Ref. 1600098-0 special length



4VLM HOSES WITHOUT INTEGRAL AIR EXHAUST FOR TURBINES, MC3 AND AQUILON MICROMOTORS

The 4VLM hose without integral air exhaust is suitable for turbines, Aquilon air micromotors and MC3 electric micromotors, with or without light. Fitted with a fixed coupling, this Swiss Made hose is manufactured from high-quality materials which ensure flexibility and long service life.



4VLM multi-purpose hose, grey

With 4-way coupling with electrical socket, Ø 10 mm hose in grey silicone, standard length 1.7 m

Ref. 1600102-001

Ref. 1600102-0 special length



4VLM multi-purpose hose, black

With 4-way coupling with electrical socket, Ø 10 mm hose in black silicone, standard length 1.7 m

Ref. 1600103-001

Ref. 1600103-0 special length



HOSE WITH FIXED COUPLING FOR MC2 MICROMOTORS

For all MC2 series electric micromotors, with or without light. Hoses with fixed couplings, delivered with an adaptor allowing the connection of motors without light. Straight or coiled hoses, black or grey. Standard length 1.7 m or special lengths up to 3 m.



Hose with fixed coupling, grey

With fixed coupling, with adapter for version without light, Ø 10 mm hose in grey silicone

Ref. 1600120-001 standard length 1.7 m

Ref. 1600120-0 special length



Hose with fixed coupling, black

With fixed coupling, with adapter for version without light, Ø 10 mm hose in black silicone

Ref. 1600297-001 standard length 1.7 m

Ref. 1600297-0 special length



Coiled hose with fixed coupling, black

With fixed coupling, with adapter for version without light, coiled black silicone

Ref. 1600315-001 standard length 1.7 m



HOSES WITH ROTATING COUPLING FOR THE MC2 WITH LIGHT

Swiss Made hose for electric micromotors with light, i.e. Isolite 100 and 300 in the MC2 series. Hoses with rotating couplings, black or grey, manufactured from high-quality materials ensuring flexibility and long service life. Standard length 1.7 m or special lengths up to 3 m.



Hose with rotating coupling, grey

With rotating coupling, Ø 10 mm hose in grey silicone

Ref. 1600298-001 standard length 1.7 m

Ref. 1600298-0 special length



Hose with rotating coupling, black

With rotating coupling, Ø 10 mm hose in black silicone

Ref. 1600299-001 standard length 1.7 m

Ref. 1600299-0 special length



STERILIZABLE CABLE FOR BASCH CHIROPRO 980 MICROMOTOR

Swiss Made cable for Basch brushless micromotor. Application in implantology. Hose and micromotor are sterilizable in an autoclave at 134°C, as per ISO Standard 7785. Standard length 3 m or special length.

135



Cable for Basch micromotor

Cable with fixed coupling, length 3 m, sterilizable in an autoclave at 134°C, black

Ref. 1600342-001

Ref. 1600342-0 special length



STERILIZABLE CABLE FOR CHIROPRO L MX-LED MICROMOTOR

Swiss Made hose for MX-LED brushless micromotor. Application in implantology, sterilizable in an autoclave at 134°C, in line with ISO 7785 standards. Length 2 m.



Cable for MX-LED Chiropro L micromotor

Cable with fixed coupling, length 2 m, sterilizable in an autoclave at 134°C, white

Ref. 1600606-001



SIMPLIFIED MAINTENANCE

Simplicity and effectiveness: these two words perfectly describe the Bien-Air range of maintenance products.

They provide you with perfect assistance in the daily use of your favourite instruments.

The Bien-Air range of maintenance products comprises four lines: Aquacare, Spraynet, Lubrifluid and Lubrimed. Each product is made for a specific cleaning and/or lubrication stage, and they work together to give your instruments impeccable hygiene and unrivalled service life.

MAINTENANCE PRODUCTS



MAINTENANCE SPRAYS



The Bien-Air range of maintenance sprays comprises three distinct products: Aquacare, Spraynet, Lubrifluid. Each spray is made for a specific cleaning and/or lubrication stage, and they combine to offer effective and very simple maintenance.

CLEANING WITH AQUACARE

Cleaning spray for handpieces and contra-angles used with physiological liquid. Particularly recommended for implantology and dental surgery instruments. Cleans irrigation tubes and dissolves impurities. Follow the recommendations given in the instructions for use, supplied with each instrument.

139



Squirt into the spray tube



Squirt into the interior of handpieces and contra-angles



Aquacare

Cleaning spray 500 ml.
Box of 6. Cleaning product for instruments used with physiological liquid
Ref. 1600617-006



Spraynet

Cleaning spray 500 ml.
Box of 6.
For instruments and equipment
Ref. 1600036-006



Lubrifluid

Spray lubricant oil, 500 ml. Box of 6.
For turbines, handpieces, contra-angles, micromotors in the MX, Basch and Aquilon families
Ref. 1600064-006

For more details, please refer to the operating instructions for the instruments and devices.

CLEANING WITH SPRAYNET

Cleaning spray for instruments and appliances.
Dissolves impurities. Follow the recommendations given in the instructions for use supplied with each instrument.



External cleaning

It is recommended that a clean cloth sprayed with Spraynet is used to clean and maintain the surfaces of hoses, cables, non-waterproof equipment and housings and electric motors. Direct spraying is perfectly suitable for all contra-angles, hand-pieces, turbines and air and brushless electric motors.



Internal cleaning

Warning: Any instrument cleaned internally with Spraynet must always be relubricated before storage or sterilization. See maintenance instructions. This procedure will ensure that the instrument runs well during each operation and for many years.

For more details, please refer to the operating instructions for the instruments and devices.

LUBRICATION WITH LUBRIFLUID

New, even more effective lubricating solution. It extends the service life of your instruments and ensures they operate correctly. Follow the recommendations given in the instructions for use supplied with each instrument.



Lubricate before each sterilization or at least twice a day.

Lubricate with the standard nozzle for hand-pieces, contra-angles and turbines with ball bearings: squirt for 1 second through the back of the instruments.



Standard nozzle and small adapter for brushless motors and air motors. Lubricate air motors via the back of the appliance for 0.5 to 1 second.

Important note

Unsuitable for non-sterilizable brush motors.

For more details, please refer to the operating instructions for the instruments and devices.

LUBRIMED MEDICAL GREASE

Medical grease for turbines with ball bearings.
Packed in boxes of 6 cartridges. Turbines are lubricated using the Lubrimed greaser.

IMPORTANT: unsuitable for Eolia turbines.



First-time use:

Remove the cap and rotate the knurled rear section until grease appears at the tip. Wipe off excess grease and put the cap back on after use.



Lubricate before each sterilization or at least twice a day.

Remove the bur and insert the tip of the greaser as far as it will go. The dose required corresponds to a half-turn of the knurled rear section. Use the reference marks.



For more details, please refer to the operating instructions for the instruments and devices.



Lubrimed

Medical grease for ball-bearing turbines, except Eolia.

Box of 6 cartridges

Ref. 1600037-006



Lubrimed greaser

For ball-bearing turbines, except Eolia

Ref. 1000003-001



Cleaning wire

For unblocking the spray ducts of turbines, contra-angles and handpieces.

Box of 10

Ref. 1000001-010

BIEN-AIR QUALITY

In order to guarantee long-term optimum performance as well as continuously renewed joy while working, Bien-Air has designed a range of top-quality accessories and control instruments. These all benefit from the same attention to detail as the other products in the range. Bien-Air quality, right down the line.

ACCESSORIES AND CONTROL INSTRUMENTS



ACCESSORIES FOR TURBINES



Key for screw chuck

Key for screw chuck
for Gyro and Gyrolina turbines.
Sterilizable

Ref. 1000000-001



Key for friction grip (FG)

Key for friction grip (FG)
for Gyro and Gyrolina turbines.
Sterilizable

Ref. 1000002-001



Box of 5 bulbs

For turbines

Ref. 1500000-005



PL 822 FO without housing

Power supply for lighting,
electronically controlled

Ref. 1600140-001



PLPE 890 FO

For powering 2 lighting systems independently,
controlled pneumatically.

Outputs with 10-second time lag

Ref. 1600142-001



2-3 way Eolia B coupling

2-3 way bayonet quick-connect coupling,
for first generation Eolia B

Ref. 1600466-010 (10 pieces)



4-way Eolia B coupling

4-way bayonet quick-connect coupling,
for first generation Eolia B

Ref. 1600467-010 (10 pieces)

ACCESSORIES FOR CONTRA-ANGLES WITH EXTERNAL IRRIGATION



Detachable irrigation set

Comprising 10 rings and 10 side tubes.

For CA 1:1 contra-angle with external irrigation

Ref. 1500431-010



Detachable Kirschner/Meyer irrigation set

Comprising 10 rings, 10 side tubes and 10 K/M tubes.

For CA 30:1 contra-angle with external irrigation

Ref. 1500467-010



Detachable Kirschner/Meyer irrigation set

Comprising 1 ring and 1 K/M tube.

For CA 30121 contra-angle with external irrigation

Ref. 1500028-001



ACCESSORIES FOR STRAIGHT HANDPIECES



PM 1:1 sleeve

With external irrigation tube.

For straight handpiece PM 1:1 ref. 1600052-001

Ref. 1500552-001



PM 1:1 sleeve

Without external irrigation tube.

For straight handpiece PM 1:1 ref. 1600052-001

Ref. 1500003-001



PM 1:2 sleeve

With external irrigation tube.

For straight handpiece PM 1:2 ref. 1600436-001

Ref. 1500567-001



PM 1:2 sleeve

Without external irrigation tube.

For straight handpiece PM 1:2 ref. 1600436-001

Ref. 1500568-001



BULBS FOR MICROMOTORS



Box of 5 bulbs

For micromotors

Ref. 1500007-005



OPTIMA MX^{INT} ACCESSORIES



Optima MX^{INT} unit

Optima MX^{INT} control unit,
controls the MX micromotor

Ref. 1600534-001



Mounting bracket

For fixing the Optima MX^{INT} control unit

Ref. 1302927-001



PL DMS relay

For Optima MX^{INT} control unit

Ref. 1500554-001



16-pin cable

For Optima MX^{INT} control unit

Ref. 1500868-001

OPTIMA MX^{INT} ACCESSORIES



Converter

Converter IN 24 Vac/OUT 32 Vdc-24 Vdc
for DMX

Ref. 1500580-001



DMX Standard

DMX Standard electronic unit
for Optima MX^{INT} control unit,
with endo functions

Ref. 1600472-001



DMX Basic

DMX Basic electronic unit
for Optima MX^{INT} control unit,
without endo functions

Ref. 1600473-001



Transformer

80-240 Vac transformer, with 5-meter 32 Vdc cable,
for Optima MX^{INT} control unit

Ref. 1600591-001

CHIROPRO L ACCESSORIES



Chiropro L irrigation lines

Set of 10 sterile, single-use irrigation lines.
For Chiropro L control unit,
flow rate adjustable from 30 - 150 ml/min

Ref. 1500984-010



Irrigation line fixing clips

Set of 10 fixing clips
for Chiropro L irrigation line

Ref. 1303711-010



Chiropro L foot pedal

Pedal with 3 buttons and variable speed drive.
Functions: progressive speed,
ON/OFF peristaltic pump, program selection,
selection of the motor's direction of rotation

Ref. 1600631-001

MISCELLANEOUS



Holder

For handpieces and motors

Ref. 1301575-001



CHIROPRO 980 ACCESSORIES

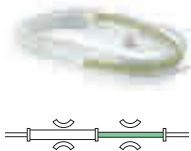

Chiropro 980 irrigation lines

Set of 10 sterile single-use irrigation lines with a choice of two flow rate ranges according to hose diameter: from 30 to 130 ml/min with the white silicone hose or from 15 to 65 ml/min with the green silicone hose

Ref. 1100037-010



Irrigation line fixing clips

Set of 10 fixing clips for Chiropro 980 irrigation line

Ref. 1300064-010



2-button pedal

For Chiropro 980 control unit

Ref. 1600281-001

MISCELLANEOUS



Holder

For handpieces and motors

Ref. 1301575-001



MEASURING INSTRUMENTS

The air pressure gauges measure the pressure of the air entering turbines and air motors. The flowmeter placed on the nose of electric motors measures the flow of cooling air.



3-way pressure gauge

For 3-way coupling

Ref. 1600242-001



4-way pressure gauge

For 4-way coupling with or without light

Ref. 1600243-001



Flow meter

For series MC2, MC3 and MX micromotors

Ref. 1600307-001

GENERAL TERMS OF SALE BIEN-AIR DENTAL SA

The terms of sale and delivery are valid for all contracts, deliveries and other services. Local sales, warranty and delivery conditions are available from the Bien-Air subsidiaries.

Technical assistance

Technical assistance for the use of our products can be provided by direct contact, in writing, via electronic media or by demonstration.

Prices, technical data

Bien-Air Dental SA reserves the right to change the prices and technical data appearing in this catalog and its documentation without prior notice

Costs and invoicing within Swiss territory and for exports

Our prices are net ex works in Swiss francs (CHF). All ancillary packaging, shipment, insurance and authorisation costs are invoiced to the customer, along with costs incurred for acceptance inspection, establishing certificates or notarized documents and any other similar costs. The minimum invoice amount is CHF 500.–.

Payment by credit card

Direct payment is accepted with the Visa®, Eurocard®, Mastercard® and American Express® credit cards. Credit card company commission is invoiced separately.



Terms of payment

Based on a written agreement in the quote or the confirmation of order. In the event of late payment, interest on arrears will be invoiced in accordance with the rate of prevailing interest as published by the Swiss Banks. If the payment date agreed by the parties is not adhered to, the customer will automatically receive formal notice.

Reservation of ownership

The goods delivered shall remain the property of Bien-Air Dental SA until full payment of the corresponding invoice.

Cost and risks

The buyer shall be responsible for the goods as soon as they leave the factory, unless other provisions are contained in the contract (Incoterms 2000).

Delivery time

Delivery times shall be complied with insofar as possible provided that the buyer supplies all the documents necessary for shipment, within the deadlines required by Bien-Air Dental SA. Cases of force majeure shall discharge Bien-Air Dental SA of all obligations. Any claim for damages shall be excluded in the event of a delivery delay unless there is serious negligence on the part of Bien-Air Dental SA.

Cancellation

All order cancellations must be approved by Bien-Air Dental SA.

Liability

Bien-Air Dental SA can only be held liable in relation to the provisions herein and in accordance with the legal provisions relating to product liability, liability as a «manufacturer» as defined in Dir. 93/42/EEC for clean medical appliances and liability as a «manufacturer» as defined Dir. 2006/42/EC for clean laboratory instruments.

The customer has sole liability for choosing products and services which meet his needs. As a professional, the customer must check the conditions of use of the products, in particular the use intended by Bien-Air Dental SA, contra-indications or warnings and, where necessary, expiry dates.

Applicable law – Jurisdiction

Swiss domestic law («Code des obligations») shall be applicable in addition to the general terms and particular agreements between the customer and Bien-Air Dental SA.

Jurisdiction: 2504 Biel/Bienne, Switzerland

GENERAL WARRANTY TERMS BIEN-AIR DENTAL SA

Bien-Air Dental SA makes every effort to provide its customers with products of impeccable quality and guarantees them, **within the limits set out herein and in special agreements concluded**, against all operating defects and material or manufacturing defects, for the following time periods starting from the invoice date and under the following conditions:

- The warranty period is 12 months for all devices.
- The warranty period is 18 months for electric micromotors in the MC2, MC3 and BASCH series.
- The warranty period is 24 months for electric micromotors in the MX, MX-LED, Prolab Basic series.

Bien-Air also offers a 24-month guarantee for the light conducting glass rods.

- Parts made from synthetic materials and bulbs are not covered by the warranty.

In general, the warranty does not exempt the customer from the obligation to contact Bien-Air for information in case of doubt and in particular when the product is used in conditions not originally explicitly provided for.

The buyer is obliged to check the goods received within 8 days of their receipt. If the goods are not checked within the period mentioned above, the customer shall be deemed to have accepted the goods, barring hidden defects..

The defect notice must be received in writing by Bien-Air within the aforementioned period and must contain the customer's name, the date of purchase, and the product reference and serial number.

In the event of complaints, Bien-Air Dental SA or its authorized representative shall repair or replace the product free of charge, after analyzing whether the complaints is justified. All other complaints of any kind whatsoever, particularly claims for damages, are excluded.

Bien-Air Dental SA shall not be held liable for damage or injury and the consequences thereof, resulting in particular from:

- excessive wear,
- inappropriate use,
- failure to comply with operating instructions, assembly instructions or maintenance instructions,
- unusual chemical, electrical or electrolytic influences,
- faulty air or water seals or electrical connections.

In any case the guarantee becomes null and void if the product is not properly serviced or is modified by third parties not authorized by Bien-Air Dental SA.

In case of dispute as to whether or not the defect exists, it shall be incumbent on the customer to prove the existence of the defect.

Guarantee claims shall be taken into consideration only upon presentation, with the product, of a copy of the invoice or delivery slip on which the date of purchase, the product reference and serial number should appear clearly.

Applicable law – Jurisdiction

Swiss domestic law («Code des obligations») shall be applicable in addition to the general terms and particular agreements between the customer and Bien-Air Dental SA.

Jurisdiction: 2504 Biel/Bienne, Switzerland

**EXTRACTS FROM ISO STANDARDS AND TABLE
OF TOOLS CORRESPONDING TO BIEN-AIR INSTRUMENTS**

To work in optimum conditions, it is necessary to use tools (burs) of high quality which meet standards relating to diameter and length. We describe below the main characteristics of the burs and indicate the reference numbers of the corresponding international standards.

**WHICH BUR FOR
WHICH BIEN-AIR INSTRUMENT?**

Information subject to technical modification, without any obligation on the part of Bien-Air Dental.

Excerpt from International Standard
ISO 6360/1, Tableau 5

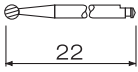
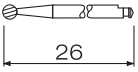
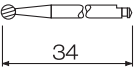
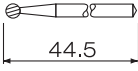
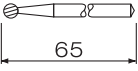
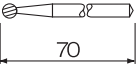
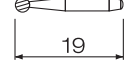
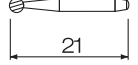
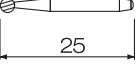
	Bur length and code number		
	Normal	Long	Extra long
ISO code 6th digit	4	5	6
Type shank 1*			
Type shank 2*			
Type shank 3*			

* Shanks as per ISO 1797

Dimensions in mm

Abbreviations of locking mechanisms

- FG** Friction Grip locking mechanism
- BI** Screw chuck locking
- BP** Push-button locking
- RO** Bur locking by rotating ring

Name of instrument	System of locking	Shank Ø in mm, ISO type	Max. total length, ISO code
Turbines for dental units			
Bora	BP	1,6 / type 3	25 / code 4 to 6
Boralina	BP	1,6 / type 3	21 / code 4 to 5
Prestige	BP	1,6 / type 3	21 / code 4 to 5
Prestilina	BP	1,6 / type 3	21 / code 4 to 5
Gyro	FG + BI	1,6 / type 3	19 / code 4
Gyrolina	FG	1,6 / type 3	19 / code 4
Eolia	BP	1,6 / type 3	21 / code 4 to 5
Black Pearl Eco	BP	1,6 / type 3	21 / code 4 to 5
Contra-angles and handpieces with internal spray			
CA 1:5	BP	1,6 / type 3	21 / code 4 to 5
CA 1:1	BP	2,35 / type 1	22 / code 4
CA 10:1	BP	2,35 / type 1	22 / code 4
PM 1:1	RO	2,35 / type 2	44,5 / code 4
Implantology contra-angles with internal irrigation			
CA 20:1	BP	2,35 / type 1	22 / code 4
Contra-angles and handpieces with external irrigation			
CA 1:1	BP	2,35 / type 1	26 / code 4 to 5
CA 30:1	BP	2,35 / type 1	34 / code 4 to 6
CA 1122	BP	2,35 / type 1	26 / code 4 to 5
CA 30121	BP	2,35 / type 1	34 / code 4 to 6
PM 1:2	RO	2,35 / type 2	44,5 / code 4
PM 1:1	RO	2,35 / type 2	44,5 / code 4
Handpieces and turbines for laboratory			
PM 1:1 ext spray	RO	2,35 / type 2	44,5 / code 4
PML 1:1	RO	2,35 / type 2	44,5 / code 4
TD 783 / TDS 890	FG	1,6 / type 3	25 / code 4 to 6

References	Descriptions	Pages
1000000-001	TOOL GYRO CHUCK	146
1000001-010	TOOL CLEANING D 0.1X23MM	143
1000002-001	TOOL BUR CHANGER GYRO	146
1000003-001	MAINT GREASER	143
1100037-010	IRRIGATION LINE	113/152
1300064-010	IRRIGATION CLIP	113/152
1300065-001	CABLE MAINS 3 POLE CH	112
1300066-001	CABLE MAINS 3 POLE EU	108/112
1300067-001	CABLE MAINS 3 POLE US	108/112
1300134-001	STYLUS	98
1301575-001	HOLDER	108/151
1302927-001	ANGLE PLATE OPTIMA MX INT	149
1303393-001	IRRIGATION BAG/BOTTLE HANGER	108
1303711-010	IRRIGATION CLIP	108/151
1304239-001	TORQUE KEY POWERCARE	61
1304240-001	ELECTRONICS MODULE POWERCARE	61
1304241-001	PM STERILIZATION BOX POWERCARE	61
1304242-001	TIPS HOLDER POWERCARE	61
1304243-001	TIP S1 POWERCARE	62
1304244-001	TIP S6 POWERCARE	62
1304245-001	TIP S7 POWERCARE	62
1304246-001	TIP S8 POWERCARE	62
1304247-001	TIP P1 POWERCARE	62
1304248-001	TIP P4 POWERCARE	62
1304249-001	TIP P10 POWERCARE	62
1304417	CONNECTOR POWERCARE	62
1500000-005	BULB TUR	146
1500003-001	SLEEVE CONE PM 1:1 EXT SPRAY	148
1500007-005	BULB MOT	148
1500017-001	IRRIGATION BAG/BOTTLE HANGER	112
1500028-001	TUBE SERUM	147
1500431-010	IRRIGATION SYSTEM	147
1500467-010	IRRIGATION SYSTEM K-MEYER	147
1500552-001	RING WITH SPRAYTUBE	148
1500554-001	BOARD RELAY	93/149
1500567-001	NOZZLE WITH TUBES SPRAY	148
1500568-001	NOZZLE	148
1500580-001	BOARD MODULE 24V-32V	93/150
1500868-001	CABLE RIBBON OPTIMA MX INT 16P	149
1500984-010	IRRIGATION LINE CHIROPRO L	108/151
1600036-006	MAINT SPRAYNET	139
1600037-006	MAINT LUBRIMED CARTRIDGE	143
1600039-001	TUR BLACK PEARL ECO 3H	43
1600040-001	TUR BLACK PEARL ECO 4H	43
1600052-001	PM 1:1 EXT SPRAY	52/119
1600064-006	MAINT LUBRIFLUID	139
1600070-001	MOT AQUILON830 IR NC	83
1600071-001	MOT MC3 IR	77
1600073-001	MOT MC2 IR	80
1600075-001	MOT MC2 GT AV	80
1600076-001	MOT BASCH	73/112
1600077-001	MOT MC3 LK	76
1600078-001	MOT ISOLITE LK	80
1600081-001	COUPLING UNIFIX 3H	124
1600082-001	COUPLING UNIFIX 4H	124
1600086-001	COUPLING UNIFIX 4H L WATER ADJ	124

References	Descriptions	Pages
1600089-001	ADAPTER 4H-3H	125
1600097-0	HOSE 4VLM11 GREY	131
1600097-001	HOSE 4VLM11 GREY	131
1600098-0	HOSE 4VLM11 BLACK	131
1600098-001	HOSE 4VLM11 BLACK	131
1600102-0	HOSE 4VLM GREY	132
1600102-001	HOSE 4VLM GREY	132
1600103-0	HOSE 4VLM BLACK	132
1600103-001	HOSE 4VLM BLACK	132
1600120-0	HOSE ISOLITE/MC2 GREY	133
1600120-001	HOSE ISOLITE/MC2 GREY	133
1600140-001	BOARD FO822	146
1600142-001	BOARD FO890	146
1600155-001	TUR BORA LK	18
1600200-001	CA 1:1 EXT SPRAY	58/118
1600238-001	CONSOLE CHIROPRO980 230V	112
1600240-001	CONSOLE CHIROPRO980 100V	112
1600241-001	CONSOLE CHIROPRO980 115V	112
1600242-001	PRESSURE GAUGE 3H	153
1600243-001	PRESSURE GAUGE 4H	153
1600278-0	COUPLING SOCKET B 4B-VX	127
1600278-001	COUPLING SOCKET B 4B-VX	127
1600281-001	FOOTCTRL CHIROPRO980	112/152
1600284-001	CA 30:1 EXT SPRAY	58/118
1600289-001	PM 10:1 PROPHY	63
1600290-001	CA 15:1 PROPHY	63
1600297-0	HOSE ISOLITE/MC2 BLACK	133
1600297-001	HOSE ISOLITE/MC2 BLACK	133
1600298-0	HOSE ISOLITE/MC2 SWMVEL GREY	134
1600298-001	HOSE ISOLITE/MC2 SWMVEL GREY	134
1600299-0	HOSE ISOLITE/MC2 SWMVEL BLACK	134
1600299-001	HOSE ISOLITE/MC2 SWMVEL BLACK	134
1600307-001	FLOWMETER MOT	153
1600315-001	HOSE ISOLITE/MC2 COILED BLACK	133
1600325-001	CA 1:5	48
1600342-0	CABLE BASCH	135
1600342-001	CABLE BASCH	112/135
1600350-001	BOARD MPPE021 FO	101
1600351-001	SET MPPE021 FO	101
1600362-001	MOT AQUILON830 SR	84
1600363-001	COUPLING UNIFIX 4H L	124
1600371-001	TUR GYROLINA FG	36
1600372-001	TUR PRESTILINA	35
1600373-001	TUR BORALINA	34
1600375-001	MOT MX	67/92
1600376-001	TUR GYRO FG	31
1600377-001	TUR GYRO SCREW C	30
1600378-001	TUR GYRO SCREW C L	28
1600379-001	TUR PRESTIGE	25
1600380-001	TUR PRESTIGE L	24
1600381-001	TUR BORA	19
1600382-001	TUR BORA L	18
1600383-001	PM 1:1	52
1600384-001	CA 1:1 L	48
1600385-001	CA 10:1 L	49
1600386-001	CA 1:5 L	48

References	Descriptions	Pages
1600387-0	HOSE 4VX GREY	127
1600387-001	HOSE 4VX GREY	92/127
1600397-0	HOSE 4VR400 GREY	129
1600397-001	HOSE 4VR400 GREY	129
1600398-0	HOSE B-4VR400 GREY	129
1600398-001	HOSE B-4VR400 GREY	129
1600424-001	CA 1:1	48
1600425-001	CA 10:1	49
1600428-0	HOSE B-4VX GREY	127
1600428-001	HOSE B-4VX GREY	98/127
1600436-001	PM 1:2	52/119
1600647-001	COUPLING EOLIA B 2H-3H	125
1600648-001	COUPLING EOLIA B 4H	125
1600459-001	CONSOLE OPTIMA MX	98
1600465-001	TUR EOLIA B	40
1600466-010	COUPLING EOLIA B 2H-3H	147
1600467-010	COUPLING EOLIA B 4H	147
1600472-001	BOARD DMX S	92/150
1600473-001	BOARD DMX BASIC	94/150
1600479-001	CA 30:1 EXT SPRAY WELDED	59/118
1600534-001	CONSOLE OPTIMA MX INT	92/149
1600591-001	TRANSFORMER 6P + EXT. TUBE 5M	93/150
1600596-001	TRANSFORMER OPTIMA MX	98
1600598-001	CA 20:1 L	56/109
1600603-001	CA 1:1 EXT SPRAY WELDED	59/118
1600605-001	MOT MX-LED	69/108
1600606-001	CABLE MX-LED	108/135
1600613-001	CONSOLE CHIROPPO L	108
1600617-006	MAINT AQUA CARE	109/139
1600631-001	FOOTCTRL CHIROPPO L	108/151
1600632-001	CA 20:1	56/113
1600637-001	TUR BORA L BLACKLINE	16
1600638-001	TUR BORA L	16
1600640-001	TUR PRESTIGE L BLACKLINE	22
1600641-001	TUR PRESTIGE L	22
1600647-001	COUPLING EOLIA B 2H-3H	125
1600648-001	COUPLING EOLIA B 4H	125
1600674-001	PM SCALER POWERCARE	61
1600675-001	HOSE SCALER POWERCARE	61
1600680-001	MOT MC3 LK	75
1600681-001	MOT ISOLITE LK	79
1700042-001	SET CA 1:1 + PM 1:1	49
1700043-001	SET B-4VR400 GREY+SOCKET B	129
1700046-001	SET MC3 LK + 4VR400 GREY	76
1700047-001	SET OPTIMA MX	98
1700058-001	SET AQUILON830 IR NC+UNIFIX 3H	84
1700074-001	SET MOT BASCH+CABLE	73/113
1700113-001	SET CHIROPPO980 230V	112
1700114-001	SET CHIROPPO980 115V	112
1700115-001	SET CHIROPPO980 100V	112
1700184-001	TUR PRESTIGE L+UNIFIX 4H L	24
1700185-001	TUR PRESTIGE+UNIFIX 3H	25
1700186-001	TUR PRESTIGE+UNIFIX 4H	25
1700187-001	TUR BORA+UNIFIX 3H	19
1700188-001	TUR BORA+UNIFIX 4H	19
1700189-001	TUR BORA L+UNIFIX 4H L	18

References	Descriptions	Pages
1700190-001	TUR GYRO SCREW C L+UNIFIX 4H L	28
1700191-001	TUR GYRO FG+UNIFIX 3H	31
1700192-001	TUR GYRO FG+UNIFIX 4H	31
1700193-001	TUR GYRO SCREW C+UNIFIX 3H	30
1700194-001	TUR GYRO SCREW C+UNIFIX 4H	30
1700196-001	SET CA 1:1 L + PM 1:1	49
1700198-001	TUR PRESTILINA+UNIFIX 3H	35
1700199-001	TUR PRESTILINA+UNIFIX 4H	35
1700200-001	TUR BORALINA+UNIFIX 3H	34
1700201-001	TUR BORALINA+UNIFIX 4H	34
1700202-001	TUR GYROLINA FG+UNIFIX 3H	36
1700203-001	TUR GYROLINA FG+UNIFIX 4H	36
1700211-001	SET AQUILON830 IR C+UNIFIX 4H	84
1700225-001	TUR EOLIA B+COUPLING 2H-3H	40
1700226-001	TUR EOLIA B+COUPLING 4H	40
1700230-001	SET DMX S	96
1700231-001	SET DMX B	97
1700232-001	SET DMX S 2M + 2C	96
1700233-001	SET DMX B 2M+2C	97
1700336-001	SET MC3 LK + 4VLM-11 GREY	76
1700337-001	SET MC3 IR + 4VLM	77
1700241-001	SET DMX S WITHOUT 24V-32V	96
1700343-001	KIT SCALER POWERCARE	61
1700245-001	SET DMX B WITHOUT 24V-32V	97
1700258-001	SET OPTIMA MX INT	92
1700259-001	SET OPTIMA MX INT 2M	93
1700260-001	SET OPTIMA MX INT BASIC	94
1700270-001	SET OPTIMA MX INT+TR.	93
1700271-001	SET OPTIMA MX INT BASIC+TR.	94
1700275-001	SET OPTIMA MX INT BASIC	93
1700298-001	SET CHIROPPO L	108
1700303-001	TUR BORA L BLACKLINE+UNIFIX	16
1700304-001	TUR PRESTIGE L BLACKLINE+UNIF	22
1700305-001	TUR BORA L+UNIFIX 4H L	16
1700306-001	TUR PRESTIGE L+UNIFIX 4H L	22
1700307-001	SET CHIROPPO L + CA 20:1 L	108

CONTENTS

- 4 - 27 CAD-CAM
Efficient and profitable solutions
- 28 - 37 LABORATORY CONTROLS
Precision, versatility and robustness
- 38 - 43 ACCESSORIES AND MAINTENANCE
Bien-Air quality

CONDITIONS AND STANDARDS

Refer to Dental pages 154-159
List of references 44-45

1



2



3



SIMPLIFYING YOUR WORKING LIFE

Backed by 50 years of experience in dental medicine, Bien-Air offers a range of solutions and products renowned throughout the world for their excellence. 100% Swiss Made, Bien-Air products are designed and manufactured in the heart of the famous «Watch Valley», the birthplace of a unique expertise in the field of micro-technology. Famous for its implantology systems and its handpieces, Bien-Air is also the world's largest producer of superior quality micromotors for dental medicine.

Our products have been developed as a direct response to the day-to-day work of professionals practicing in the dental and surgical fields. The constant innovations emerging from this close collaboration greatly improve the quality, fluidity and safety of dental treatments and surgical procedures. Our customers testify daily to the high quality, reliability and precision of our products. They are made to simplify your working life... for a long time.



EFFICIENT AND PROFITABLE SOLUTIONS

With Bien-Air, it has never been so easy to design and machine superior quality prosthetics in your laboratory. Thanks to an obsession with simplicity and reliability, the specialists at Bien-Air Laboratory have developed a CAD-CAM system able to meet the very highest requirements.

The Bien-Air CAD-CAM system pushes the limits of precision, ease of use and profitability even further.

Quality prosthetics also means quality materials. This is why Bien-Air Laboratory provides you with ten renowned prosthetic materials, covering all the needs of a modern dental laboratory.

CAD-CAM



CAD-CAM SOLUTIONS TO MEET YOUR EVERY NEED



Advantages of the Bien-Air CAD-CAM system:

- easy to use
- top quality results
- versatile
- quick machining
- wide selection of prosthetic materials
- compact design perfect for laboratories
- adaptable software
- open system (STL)



The Bien-Air CAD-CAM system is comprised of a scanner (Scan200), a prosthetic design software package (DentCAD), machining program software (DentMILL), and a CNC milling machine (Mill200). The whole system is controlled by a computer.

This open system makes it possible to use standard STL files.

You can thus receive and exchange files on incomplete or finished prosthetics with your partners.

High quality equipment and materials, rapid machining, unrivalled ease of use, unique versatility, future proof software and incomparable results: all these reasons have earned Bien-Air its worldwide reputation.

You can't go wrong.

Systems	Mill200
Inlays/Onlays/Veneers	•
One-piece crowns	•
Bridges of 3 to 14 elements	•
Bridges-Inlays	•
Glued bridges	•
Telescopic crowns	•
Implants-Abutments	•

SCAN200



To obtain a quality prosthetic, you have to start with a good quality scan of the impression. The Scan200 offers you the best in industrial technology right from the start of the process, and is very easy to use. It is able to scan up to 14 elements at a time, with the same guaranteed precision, whatever type of plaster is used. The frame of the Scan200 plays a fundamental role. Made entirely of steel, it ensures perfect stability during the scanning process. The result? Unrivalled precision and clarity, showing the most minute details. What is more, its ultra-precise drive mechanism allows for great freedom of movement, for perfect images with no holes or dead zones. The control program itself is both comprehensive and user friendly.



Scan200 specifications:

- indications: crowns, inlays, pontic, wax-up and checkbite
- can scan from a single element to a full arch at a time
- scan surface area: 100 mm diameter
- white light technology (fringe scan)
- 2 high-resolution cameras
- precision: 20 microns
- noise level less than 5 microns
- repeatability: 10 microns
- rapidity: 60 to 90 seconds per element
- autocalibration: 30 seconds
- multi-die option
- external dimensions in mm: L 450 x H 630 x D 300
- weight: 22 kg

Bien-Air Scan200 including DentCAD (CAD)

Set comprising DentCAD software, PC*, keyboard, mouse
Ref. 1700288-001

Bien-Air CAD-CAM System

Set comprising:

Bien-Air Scan200 incl. DentCAD (CAD) ref. 1700288-001

Bien-Air Mill200 incl. DentMILL (CAM) ref. 1700290-001

Training and installation

Ref. 1700283-001

* PC with screen, keyboard and mouse, configuration: T3400: 525W Intel Core 2 Quad Q9550 (2.83GHz, 1333MHz, 12MB), 4GB DDR2 800MHz ECC Dual Channel Memory (4x1GB), Hard disc: 500Go Serial ATA II (7200 rpm), Player 16X DVD-ROM, Screen: 20" 2007FP Suisse Noir UltraSharp (1600 x 1200) TC099 DVI-D, 512MB PCIe x16 nVidia Quadro FX 1700 (MRGA14L), Dual Monitor DVI or VGA Graphics Card.

MILL200 TECHNOLOGY AND INGENUITY COMBINED



A veritable concentration of technology and ingenuity, this 100% Swiss-made machine rivals the best industrial CNC machines. The Mill200 is fitted with an SD card reader for the exchange of data. With ball screw spindles connected to the axis motors, the machine offers extraordinary precision in repeated positioning. The ultra-stable cast iron structure of the Mill200 absorbs most vibrations. The vertically positioned vice for holding materials allows rapid downward evacuation of chips and dust. The service life of these tools is longer and the precision of machining has been further improved. The linear movements are ensured by high precision recirculating ball slide rails. These guarantee a very long service life. Quality is never left to chance!

Characteristics Mill200:

- effective machine volume: blanks Ø 90 mm x d 20 mm
- spindles: 2 x Ø 38 mm
- chuck: ER16, Ø 10 mm max.
- motor speed: 300 - 25,000 rpm, 0.45 kW
- liquid cooled
- automatic measurement of tool length
- travel X: 255 mm, Y: 150 mm, Z: 100 mm
- rapid traverse 10 m/min
- minimum resolution of 1 micron
- pneumatic turning of material, 180°
- integrated computerized numerical control
- electronic knob controlling movement of the linear axes, resolution 1 micron
- ISO language programming
- SD card reader for loading and storing programs
- electrical connection: 230 V/50 Hz
- pneumatic connection: 5 bars
- dimensions (L/H/D) weight: 800 x 700 x 800 mm/170 kg



Bien-Air Mill200 including DentMILL (CAM)

Set comprising 2 additional chucks, DentMILL software, plus blocks of the following materials: 1x DC-Shrink®, 5x DC-Tell®, 1x DC-Titan®, 1x DC-Cast®, 1x set DC-Liner, 1x DC-Cor red, 1x DC-Cor white. Also 1 set of tools, 1x coolant liquid plus training and installation

Ref. 1700290-001

Bien-Air Mill200 without DentMILL (CAM)

Additional milling machine including: 2 additional chucks, 1 set of tools, 1x coolant liquid plus installation

Ref. 1600627-001

Bien-Air CAD-CAM System

Set comprising:

Bien-Air Scan200 incl. DentCAD (CAD) ref. 1700288-001

Bien-Air Mill200 incl. DentMILL (CAM) ref. 1700290-001

Training and installation

Ref. 1700283-001

DENTCAD / DENTMILL

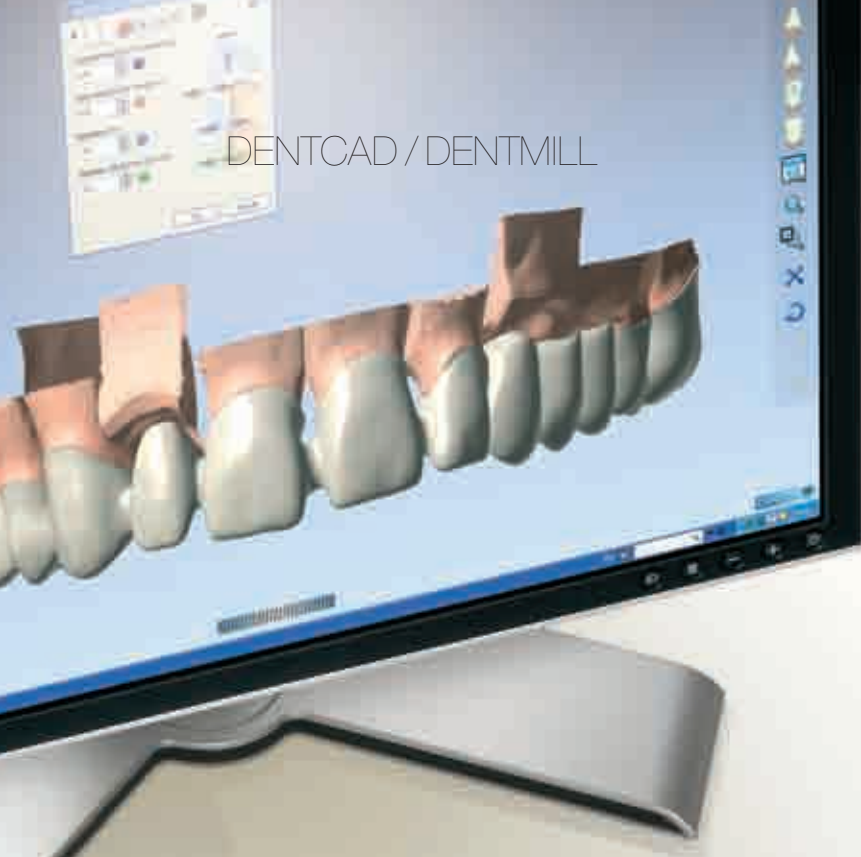

DENTCAD

Thanks to DentCAD, computer-assisted design of prosthetics has never been so easy. A powerful processing program, DentCAD allows you to design prosthetics quickly and intuitively with truly professional results. Powerful functions are available to make life easier. You'll love the complete and user-friendly graphic user interface.

DENTMILL

The product of 25 years' experience, DentMILL is a CAM software package enabling you to configure and control the machine's programming and milling operations. DentMILL is so simple to use that there is no need for any prior CAM experience. No more wasted time: the optimum machining programs are automatically recommended to you. The results obtained using DentMill are amazing. The surface finish is of such a high quality that hand finishing work is not necessary.

DentMILL specifications (CAM):

- simple to use, graphic user interface
- simplified and automatic anatomical design of copings and bridges
- preparation line management
- cement space adjustment
- coping shape modification
- full library of tooth models
- fully customizable

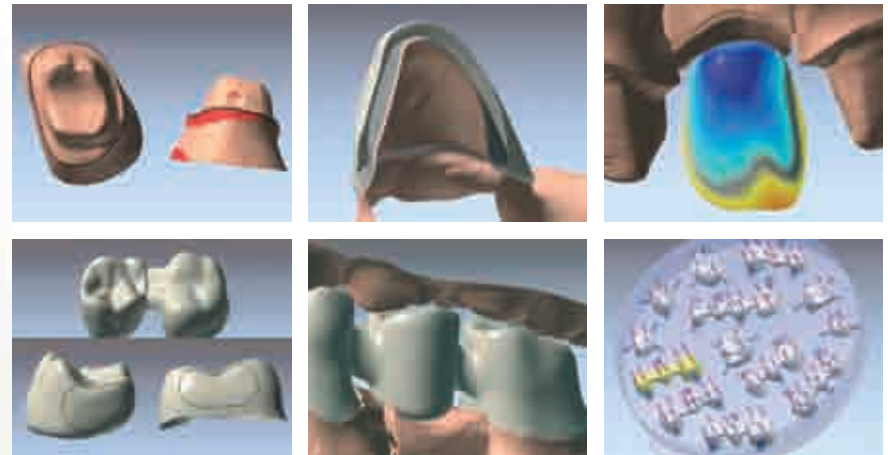

DentMILL (CAM) specifications:

- simple to use, graphic user interface
- preset machine programs
- no CNC experience necessary
- optimized use of material (nesting)
- no limit to number of elements
- compensation for the shrinkage coefficient can be configured (thermal treatment)

PROSTHETIC MATERIALS A SOLUTION FOR YOUR EVERY NEED

Bien-Air Laboratory offers you a range of certified prosthetic materials recognized* for their top-level performance. Suitable for all requirements, the Bien-Air range offers you a broad range of solutions, from highly-affordable temporary materials to DC-Zirkon®, renowned for its aesthetic qualities and great strength.

To perfect this range, Bien-Air has collaborated with various universities and well-known international institutes, resulting in materials with a fine homogeneous structure. Their unique characteristics allow faster machining and provide exceptional quality.

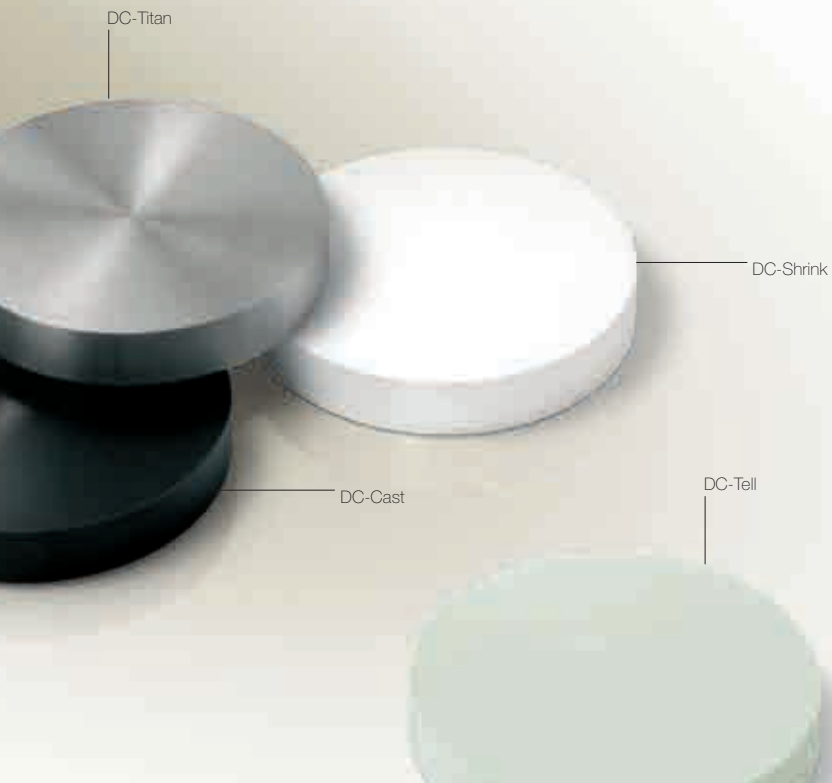

The most recent of these, **DC-Croco®** is a cobalt alloy of proven quality, industrially produced and used to make the frames of crowns and bridges.

As well as **DC-Zirkon®** and **DC-Zirkon® col.**, absolute classics that were placed on the market in 1993 and are suitable for numerous indications (fully sintered zirconium), you have the choice of **DC-Shrink®** (densely sintered zirconium) and **DC-Leolux®** (fully sintered zirconium). Our range of «all ceramic» aluminium products, which includes **DC-Procura®**, provides a practical response to all user requirements. This range also includes the vitro-ceramics **DC-Cristall®** and **DC-Cream®**.

The **DC-Titan®** (single metal), is covered by the layer of bio-oxides. For non-precious alloys, we go back to **DC-Croco®**.

A «low cost» segment that is currently enjoying success: long-lasting temporary prosthetics made from **DC-Tell®** reinforced with fiberglass and **DC-Cast®** designed for the «lost-wax» casting technique.

DC-Zirkon®, due to its incomparable aesthetic properties and great strength, has become a real bestseller. These qualities are particularly remarkable due to the enormous level of hot isostatic pressing (HIP) to which it is subjected. The technical perfection phase took place in collaboration with various universities and made it possible to reduce the implementation time and also to optimize the material. Its long machining time becomes relative since the heating phase (sintering) is not necessary. **DC-Zirkon®** offers essential advantages to demanding professionals.

* Prosthetic material blocks are class IIIa medical devices according to European directive 93/42/CEE.

BLOCKS OF MATERIAL

Description Size in mm



DC-Zirkon® blocks

Zirconium Oxide HIP (hot isostatic pressing)

Ref. 1501143-001	Ø 90 x 8
Ref. 1501144-001	Ø 90 x 10
Ref. 1501145-001	Ø 90 x 12
Ref. 1501146-001	Ø 90 x 13.5
Ref. 1501147-001	Ø 90 x 15
Ref. 1501279-001	Ø 90 x 20
Ref. 0410.00500	80 x 50 x 8
Ref. 0410.00501	80 x 50 x 10
Ref. 0410.00502	80 x 50 x 12
Ref. 0410.00503	80 x 50 x 13.5
Ref. 0410.00504	80 x 50 x 15



DC-Zirkon® col. blocks

Zirconium Oxide HIP (colored hot isostatic pressing)

Ref. 1501148-001	Ø 90 x 8
Ref. 1501149-001	Ø 90 x 10
Ref. 1501150-001	Ø 90 x 12
Ref. 1501151-001	Ø 90 x 13.5
Ref. 1501152-001	Ø 90 x 15
Ref. 1501280-001	Ø 90 x 20
Ref. 0410.00510	80 x 50 x 8
Ref. 0410.00511	80 x 50 x 10
Ref. 0410.00512	80 x 50 x 12
Ref. 0410.00513	80 x 50 x 13.5
Ref. 0410.00514	80 x 50 x 15



DC-Shrink® blocks

Recommended sintering furnaces:

* Vita Zyrcomat, * Mihm-Vogt HT	
Ref. 1501168-001	Ø 90 x 15
Ref. 1501169-001	Ø 90 x 20
Ref. 0410.00754	80 x 50 x 15

Blocks of different dimensions available on request.
In the absence of specific indications, the material is intended for crowns and bridges.

*Vita Zyrcomat and Mihm-Vogt HT are registered trade marks of the companies of the same name.

Description Size in mm



DC-Leolux® blocks

Ref. 1501161-001	Ø 90 x 12
Ref. 1501162-001	Ø 90 x 15
Ref. 0410.00562	80 x 50 x 12
Ref. 0410.00564	80 x 50 x 15



DC-Procura® blocks

For one-piece crowns only

Ref. 1501163-001	Ø 90 x 8
Ref. 1501164-001	Ø 90 x 10
Ref. 1501165-001	Ø 90 x 12
Ref. 1501166-001	Ø 90 x 13.5
Ref. 1501167-001	Ø 90 x 15
Ref. 0410.00520	80 x 50 x 8
Ref. 0410.00521	80 x 50 x 10
Ref. 0410.00522	80 x 50 x 12
Ref. 0410.00523	80 x 50 x 13.5
Ref. 0410.00524	80 x 50 x 15



DC-Cristall® blocks

For one-piece crowns only

Ref. 1501153-001	Ø 90 x 12
Ref. 0410.00552	80 x 50 x 12



DC-Cream® blocks

For one-piece crowns only

Ref. 1501158-001	Ø 90 x 12
Ref. 0410.00702	80 x 50 x 12



Description	Size in mm
DC-Titan® blocks	
Ref. 1501172-001	Ø 90 x 8
Ref. 1501173-001	Ø 90 x 10
Ref. 1501174-001	Ø 90 x 12
Ref. 1501175-001	Ø 90 x 13.5
Ref. 1501176-001	Ø 90 x 15
Ref. 1501178-001	Ø 90 x 20
Ref. 0410.00012	80 x 50 x 8
Ref. 0410.00004	80 x 50 x 10
Ref. 0410.00005	80 x 50 x 12
Ref. 0410.00006	80 x 50 x 13.5
Ref. 0410.00007	80 x 50 x 15



DC-Croco® blocks	
Ref. 1501159-001	Ø 90 x 12
Ref. 1501160-001	Ø 90 x 15
Ref. 0410.00024	80 x 50 x 12
Ref. 0410.00026	80 x 50 x 15



DC-Tell® blocks	
Ref. 1501170-001	Ø 90 x 15
Ref. 1501171-001	Ø 90 x 20
Ref. 0410.01500	80 x 50 x 15



DC-Cast® blocks	
For casting, lost-wax technique	
Ref. 1501156-001	Ø 90 x 15
Ref. 1501157-001	Ø 90 x 20
Ref. 0410.00994	80 x 50 x 15



Blocks of different dimensions available on request.
In the absence of specific indications, the material is intended for crowns and bridges.

CONSUMABLES FOR QUALITY WITHOUT COMPROMISE



Retouching products, coolant liquid, anti-foam, burs: Bien-Air has created a range of consumables allowing you to optimize your results. They have been specially designed for Bien-Air machines and materials. For quality without compromise.

DC-LINER

Bonded to zirconium oxide, DC-Liner gives it a natural and fluorescent appearance. The white translucent surface of the zirconium oxide thus has a beneficial effect on the aesthetics of the final restoration. DC-Liner is manufactured using high-quality dental ceramics based on selected raw materials. The use of DC-Liner is always advantageous when zirconium oxide frameworks are to be veneered.

DC-Liner Z1 - Z6

10 g pots

0440.90010 Z1 - light

0440.90011 Z2 - reddish

0440.90012 Z3 - yellowish

0440.90013 Z4 - brownish

0440.90014 Z5 - bright/intensive

0440.90015 Z6 - grey



DC-Liner set

Contents:

DC-Liner Z1, Z3, Z5, Z6, 2x fluid

Ref. 0440.90000

DC-Liner, transparent liquid

1x 15 ml bottle

Ref. 0440.90021



DC-Liner, colored liquid

1x 15 ml bottle

Ref. 0440.90020



DC-COR

DC-Cor is a thermoplastic material that is used to correct small margin step defects in zirconium oxide frameworks.



DC-Cor
White, 2 tablets
Ref. 0410.00540



DC-Cor
Red, 2 tablets
Ref. 0410.00541



Zircon oxide test tablet
10 pieces
Ref. 0410.00530

LIQUIDS FOR MACHINES

Antifoaming liquid and coolant fluid for the machine center.



Coolant fluid
5 liters
Ref. 0440.00150



Anti-foam
1 liter
Ref. 0450.10022

Filter for machine
100 μ m
Ref. 0440.10002

BURS FOR BIEN-AIR MILL200

First-choice tools manufactured from extra-strength tungsten carbide, with a cutting edge specially adapted to suit the parameters of the Mill200. Precision and longevity combine to meet your most stringent demands.



Tungsten carbide bur
For DC-Shrink®, DC-Tell® and DC-Cast®
Ø 1 mm
Box of 2
Ref. 1304134-002



Tungsten carbide bur
For DC-Titan®
Ø 1.5 mm
Box of 2
Ref. 1304135-002



Tungsten carbide bur
For DC-Shrink®, DC-Tell® and DC-Cast®
Ø 3 mm
Box of 2
Ref. 1304136-002

BURS FOR DCS PRECIDENT SYSTEM

High quality tools to meet your most stringent requirements. Made of tungsten carbide or diamond, or specially dimensioned for DC-Croco®, they are particularly precise and hard-wearing in order to guarantee a long service life.



Tungsten carbide bur
Ø 1 mm
Box of 5
Ref. 0420.00000



Tungsten carbide bur
Ø 1.5 mm
Box of 5
Ref. 0420.00001



Tungsten carbide bur
Ø 2 mm
Box of 5
Ref. 0420.00002



Tungsten carbide bur
Ø 3 mm
Box of 5
Ref. 0420.00003



Tungsten carbide bur for DC-Croco®
Ø 1 mm
Box of 5
Ref. 0420.02001



Tungsten carbide bur for DC-Croco®
Ø 1.5 mm
Box of 5
Ref. 0420.02002



Tungsten carbide bur for DC-Croco®
Ø 2 mm
Box of 5
Ref. 0420.02003



Tungsten carbide bur for DC-Croco®
Ø 3 mm
Box of 5
Ref. 0420.02004



Diamond bur
Ø 1 mm
Box of 5
Ref. 0420.01010



Diamond bur
Ø 1.5 mm
Box of 5
Ref. 0420.01001



Diamond bur
Ø 2 mm
Box of 5
Ref. 0420.01002



Diamond bur
Ø 3 mm
Box of 5
Ref. 0420.01004



Diamond bur
Ø 5 mm
Box of 5
Ref. 0420.01006

PRECISION, VERSATILITY AND ROBUSTNESS

Particularly simple and robust, Bien-Air laboratory systems or instruments enjoy a reputation for performance and reliability that is already firmly established. Backed by more than 50 years of experience in the field of rotary instruments, at first pneumatic then using electric micromotors, Bien-Air has been able to meet the increasing demands involved in the retouching of prosthetics and ceramics in the laboratory. You will find an indispensable assistant in the range of laboratory systems or instruments from Bien-Air.

LABORATORY CONTROLS



PNEUMATIC CONTROLS



Particularly robust and simple to use, Bien-Air pneumatic units and their TD and TDS turbines provide the optimum response to the demands of ceramics and prosthetics specialists. Ideal for delicate, precise work, robust and simple to use, these units are unrivalled.

The STS Trimmer unit stands out due to its superior qualities. Fitted with a 1.4 liter tank, it can operate autonomously for significant periods. Controlled by separate switches, the flow rate and the air/water spray mixture can be finely adjusted for optimum cooling.

In combination with turbines fitted with a dustproof shield and Friction Grip chuck, Bien-Air pneumatic assemblies offer you the best... over the long-term.

STS-TRIMMER PNEUMATIC CONTROL WITH SPRAY

Simple and efficient table control with a large tank, fitted with the TDS 890 straight turbine.

Specifications:

- controls the TDS 890 turbine with spray
- turbine speed up to 300,000 rpm
- turbine ideal for delicate, precise work
- large 1.4 liter tank
- air/water mixture plus adjustable spray flow rate
- manual spray switch
- pedal to adjust turbine speed and activate spray
- straight hose in grey silicone, 4-way coupling
- reliability under all conditions
- allows machining of ceramic and zirconia



STS-Trimmer unit with spray

- 1 STS -Trimmer unit with spray ref. 1600643-001
- 1 TDS 890 turbine with internal spray ref. 1600163-001
- 1 pedal ref. 1600312-001
- 1 straight hose with 4-way coupling ref. 1600390-001

Ref. 1700296-001

PNEUMATIC CONTROLS FOR TD 783 TURBINES

Simple and efficient controls, fitted with the TD 783 straight turbine. A choice of two versions, the S001 table model, stable yet compact, or the SF811 wall or table-leg mounted unit, for extra working space.

Specifications:

- turbine speed up to 300,000 rpm
- turbine ideal for delicate, precise work
- pedal to adjust turbine speed
- straight hose in grey silicone, internal Ø 1/8"
- reliability under all conditions



S001 set

- | | |
|-------------------------------------|------------------|
| 1 S001 table model | ref. 1600318-001 |
| 1 TD 783 turbine | ref. 1600161-001 |
| 1 pedal | ref. 1600312-001 |
| 1 coiled grey hose, internal Ø 1/8" | ref. 1200022-001 |
- Ref. 1700126-001**



SF 811 set

- | | |
|-------------------------------------|------------------|
| 1 SF 811 wall-mounted unit | ref. 1600167-001 |
| 1 TD 783 turbine | ref. 1600161-001 |
| 1 pedal | ref. 1600312-001 |
| 1 coiled grey hose, internal Ø 1/8" | ref. 1200022-001 |
- Ref. 1700083-001**

STRAIGHT TURBINES

With a speed of 300,000 rpm, these straight laboratory turbines prove ideal for delicate, precise work. A dust protection shield, unique to Bien-Air, helps give them an extraordinarily long service life.



TD 783 turbine

For connection to hose, internal Ø 1/8" (3.17 mm), friction grip (FG), bur shank Ø 1.6 mm
Ref. 1600161-001



TD 783 turbine

For 2-way coupling hose, friction grip (FG), bur shank Ø 1.6 mm
Ref. 1600162-001



TDS 890 turbine with spray

For station with STS-Trimmer spray, friction grip (FG), 4-way coupling, bur shank Ø 1.6 mm
Ref. 1600163-001



ELECTRICAL CONTROL



PROLAB Basic has become an essential tool. This unit and its motor place Bien-Air quality within the reach of all handpieces with type E couplings. This is a robust, high-performance micromotor. Designed without brushes or sensors, it is fitted with a self-ventilation system. Specially designed for laboratory controls, it displays vibration-free rotation and smooth acceleration at all speeds. The ideal extension for the Prolab motor, the PML 1:1 direct ratio straight handpiece is fitted with reinforced locking and an anti-rotation system on the highly efficient motor. Prolab Basic, you can no longer do without it.

PROLAB BASIC TABLE CONTROL

Prolab Basic laboratory table control with progressive control pedal. For 100, 115 and 230 Vac.



Prolab Basic set with progressive pedal

- | | |
|---------------------------|------------------|
| 1 Prolab Basic table unit | ref. 1600442-001 |
| 1 motor 1000 - 40,000 rpm | ref. 1600443-001 |
| 1 motor cable | ref. 1600431-001 |
| 1 progressive pedal | ref. 1600440-001 |
| 1 holder | ref. 1301575-001 |

Ref. 1700252-001

PROLAB BASIC TABLE CONTROL

Prolab Basic laboratory table control with ON/OFF control pedal.
For 100, 115 and 230 Vac.



Prolab Basic set with ON/OFF pedal

1 Prolab Basic table unit	ref. 1600442-001
1 motor 1000 - 40,000 rpm	ref. 1600443-001
1 motor cable	ref. 1600431-001
1 ON/OFF pedal	ref. 1600447-001
1 holder	ref. 1301575-001

Ref. 1700041-001

STRAIGHT HANDPIECES



PML 1:1

Laboratory handpiece, direct ratio,
locking ring, with retractable anti-rotation catch,
bur shank \varnothing 2.35 mm

Ref. 1600156-001



PM 1:1

Without light, direct ratio,
Interchangeable sleeves with or without irrigation tube,
locking ring, bur shank \varnothing 2.35 mm

Ref. 1600052-001



PM 1:1 sleeve

Without external irrigation tube.

For straight handpiece PM 1:1 ref. 1600052-001

Ref. 1500003-001



BIEN-AIR QUALITY

In order to guarantee long-term optimum performance as well as constantly renewed pleasure in one's work, Bien-Air has designed a range of top-quality accessories and control instruments. These all benefit from the same attention to detail as the other products in the product line. Bien-Air quality, right down the line.

MAINTENANCE AND ACCESSORIES



MAINTENANCE PRODUCTS



Spraynet

Cleaning spray 500 ml.
Box of 6.
For instruments and equipment
Ref. 1600036-006



Lubrimed

Medical grease for ball-bearing turbines, except Eolia.
Box of 6 cartridges
Ref. 1600037-006



Lubrimed greaser

For ball-bearing turbines, except Eolia
Ref. 1000003-001



Cleaning wire

For unblocking the spray jets of turbines,
contra-angles and handpieces.
Box of 10
Ref. 1000001-010

PROLAB BASIC ACCESSORIES



Progressive foot pedal
Prolab Basic
Ref. 1600440-001



ON/OFF foot pedal
Prolab Basic
Ref. 1600447-001



Unit mounting
Prolab Basic
Ref. 1301220-001



Holder
For handpieces and motors
Ref. 1301575-001

PROLAB BASIC ACCESSORIES



Prolab Basic micromotor
Self-ventilating, type E coupling
compliant with ISO 3964, rotation speed
1,000 – 40,000 rpm
Ref. 1600443-001



Prolab Basic black cable
For micromotor, length 3 m
Ref. 1600431-001

ACCESSORIES FOR TD 783 AND TDS 890 TURBINES



Chuck pusher with friction grip (FG)
For TD 783 and TDS 890 turbines
Ref. 1000005-001



2-3 way coupling
Allows use of the TD 783 turbine
with 2-way coupling
on S001 and SF 811 stations
Ref. 1500010-001

MEASURING INSTRUMENTS

The air pressure gauges measure the pressure of the air entering the turbines and air motors.



3-way pressure gauge
For 3-way coupling
Ref. 1600242-001



4-way pressure gauge
For 4-way coupling
with or without light
Ref. 1600243-001



Références	Désignations	Pages
0410.00004	DC-TITAN® 80X50X10	18
0410.00005	DC-TITAN® 80X50X12	18
0410.00006	DC-TITAN® 80X50X13.5	18
0410.00007	DC-TITAN® 80X50X15	18
0410.00012	DC-TITAN® 80X50X8	18
0410.00024	DC-CROCO® 80X50X12	18
0410.00026	DC-CROCO® 80X50X15	18
0410.00500	DC-ZIRKON® 80X50X8	16
0410.00501	DC-ZIRKON® 80X50X10	16
0410.00502	DC-ZIRKON® 80X50X12	16
0410.00503	DC-ZIRKON® 80X50X13.5	16
0410.00504	DC-ZIRKON® 80X50X15	16
0410.00510	DC-ZIRKON® COL. 80X50X8	16
0410.00511	DC-ZIRKON® COL. 80X50X10	16
0410.00512	DC-ZIRKON® COL. 80X50X12	16
0410.00513	DC-ZIRKON® COL. 80X50X13.5	16
0410.00514	DC-ZIRKON® COL. 80X50X15	16
0410.00520	DC-PROCURA® 80X50X8	17
0410.00521	DC-PROCURA® 80X50X10	17
0410.00522	DC-PROCURA® 80X50X12	17
0410.00523	DC-PROCURA® 80X50X13.5	17
0410.00524	DC-PROCURA® 80X50X15	17
0410.00530	ZIRKONOXID TESTTABLETS (10PCES)	22
0410.00540	DC-COR WHITE (2 TABLETS)	22
0410.00541	DC-COR RED (2 TABLETS)	22
0410.00552	DC-CRISTALL® 80X50X12	17
0410.00562	DC-LEOLUX® 80X50X12	17
0410.00564	DC-LEOLUX® 80X50X15	17
0410.00702	DC-CREAM® 80X50X12	17
0410.00754	DC-SHRINK® 80X50X15	16
0410.00994	DC-CAST® 80X50X15	18
0410.01500	DC-TELL® 80X50X15	18
0420.00000	CARBIDE END MILL Ø1 (5 PCES)	25
0420.00001	CARBIDE END MILL Ø1.5 (5 PCES)	25
0420.00002	CARBIDE END MILL Ø2 (5 PCES)	25
0420.00003	CARBIDE END MILL Ø3 (5 PCES)	25
0420.01001	DIAMOND BURR Ø1.5 (5 PCES)	27
0420.01002	DIAMOND BURR Ø2 (5 PCES)	27
0420.01004	DIAMOND BURR Ø3 (5 PCES)	27
0420.01006	DIAMOND BURR Ø5 (5 PCES)	27
0420.01010	DIAMOND BURR Ø1 (5 PCES)	27
0420.02001	DC-CROCO® END MILL Ø1 (5 PCES)	26
0420.02002	DC-CROCO® END MILL Ø1.5 (5 PC)	26
0420.02003	DC-CROCO® END MILL Ø2 (5 PCES)	26
0420.02004	DC-CROCO® END MILL Ø3 (5 PCES)	26
0440.00150	COLLANT LIQUID 5L	23
0440.10002	FILTER BAG 100UM (M3, M4)	23
0440.90000	DC-LINER SET	21
0440.90010	DC-LINER Z1-LIGHT	21
0440.90011	DC-LINER Z2-REDDISH	21
0440.90012	DC-LINER Z3-YELLOWISH	21
0440.90013	DC-LINER Z4-BROWNISH	21
0440.90014	DC-LINER Z5-BRIGHT/INTENSIVE	21
0440.90015	DC-LINER Z6-GREY	21
0440.90020	DC-LINER FLUID COLOURED	21
0440.90021	DC-LINER FLUID CLEAR	21
0450.10022	ANTIFOAM 1L	23
1000001-010	TOOL CLEANING D 0.1X23MM	40
1000003-001	MAINT GREASER	40
1000005-001	TOOL BUR CHANGER TD/TDS	42
1200022-001	HOSE CONSOLE S001/SF811 GREY	32
1301220-001	HOLDER PROLAB	41
1301575-001	HOLDER PM	35/36/40
1304134-002	MILL 200 FRAISE CARBURE 1MM	24
1304135-002	MILL 200 FRAISE CARBURE 1,5MM	24
1304136-002	MILL 200 FRAISE CARBURE 3MM	24

Références	Désignations	Pages
1500003-001	SLEEVE CONE PM 1:1 EXT SPRAY	37
1500010-001	BORDEN COUPLING (BRAIDED)	42
1501143-001	DC-ZIRKON® Ø90X8	16
1501144-001	DC-ZIRKON® Ø90X10	16
1501145-001	DC-ZIRKON® Ø90X12	16
1501146-001	DC-ZIRKON® Ø90X13.5	16
1501147-001	DC-ZIRKON® Ø90X15	16
1501148-001	DC-ZIRKON® COL. Ø 90X8	16
1501149-001	DC-ZIRKON® COL. Ø 90X10	16
1501150-001	DC-ZIRKON® COL. Ø 90X12	16
1501151-001	DC-ZIRKON® COL. Ø 90X13.5	16
1501152-001	DC-ZIRKON® COL. Ø 90X15	16
1501153-001	DC-CRISTALL® Ø90X12	17
1501156-001	DC-CAST® Ø 90X15	18
1501157-001	DC-CAST® Ø 90X20	18
1501158-001	DC-CREAM® Ø 90X12	17
1501159-001	DC-CROCO® Ø 90X12	18
1501160-001	DC-CROCO® Ø 90X15	18
1501161-001	DC-LEOLUX® Ø 90X12	17
1501162-001	DC-LEOLUX® Ø 90X15	17
1501163-001	DC-PROCURA® Ø 90X8	17
1501164-001	DC-PROCURA® Ø 90X10	17
1501165-001	DC-PROCURA® Ø 90X12	17
1501166-001	DC-PROCURA® Ø 90X13.5	17
1501167-001	DC-PROCURA® Ø 90X15	17
1501168-001	DC-SHRINK® Ø 90X15	16
1501169-001	DC-SHRINK® Ø 90X20	16
1501170-001	DC-TELL® Ø 90X15	18
1501171-001	DC-TELL® Ø90X20	18
1501172-001	DC-TITAN® Ø 90X8	18
1501173-001	DC-TITAN® Ø 90X10	18
1501174-001	DC-TITAN® Ø 90X12	18
1501175-001	DC-TITAN® Ø 90X13.5	18
1501176-001	DC-TITAN® Ø 90X15	18
1501178-001	DC-TITAN® Ø 90X20	18
1501279-001	DC-ZIRKON® Ø 90X20	16
1501280-001	DC-ZIRKON® COL. Ø 90X20	16
1600036-006	MAINT SPRAYNET	40
1600037-006	MAINT LUBRIMED CARTRIDGE	40
1600052-001	PM 1:1 EXT SPRAY	37
1600156-001	PM PROLAB BASIC	37
1600161-001	TUR TD783	32/33
1600162-001	TUR TD783 2H	33
1600163-001	TUR TDS890 4H	31/33
1600167-001	CONSOLE SF811	32
1600242-001	PRESSURE GAUGE 3H	43
1600243-001	PRESSURE GAUGE 4H	43
1600312-001	FOOTCTRL PNEUMATIC	31/32
1600318-001	CONSOLE S001	32
1600390-001	HOSE STS890 4H	31
1600431-001	CABLE MOT PROLAB	35/36/42
1600440-001	FOOTCTRL PROLAB	35/41
1600442-001	CONSOLE PROLAB BASIC	35/36
1600443-001	MOT PROLAB BASIC	35/36/42
1600447-001	FOOTCTRL PROLAB BASIC	36/41
1600624-001	COMPUTER LAB SECTION	9/11
1600627-001	MACHINE MILL 200	11
1600643-001	CONSOLE STS TRIMMER	31
1700041-001	SET PROLAB BASIC	36
1700083-001	SET SF811+TD783	32
1700126-001	SET S001+TD783	32
1700252-001	SET PROLAB BASIC FTCTRL	35
1700283-001	CAD/CAM SYSTEM (SCAN+MILL 200)	9/11
1700288-001	SCANNER SCAN 200 + CAD	9/11
1700290-001	MACHINE MILL 200 + CAM	9/11
1700296-001	SET STS-TRIMMER	31